

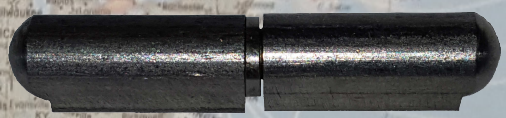

Northeast Hinge Distributors, Inc.

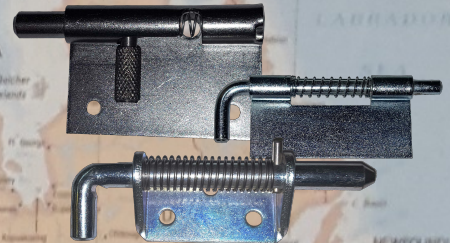
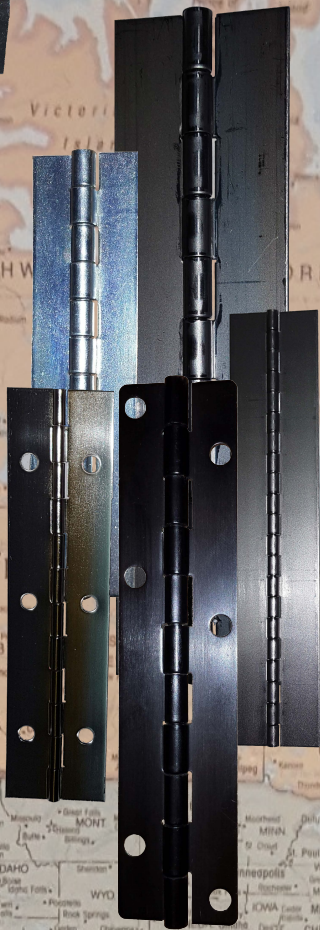
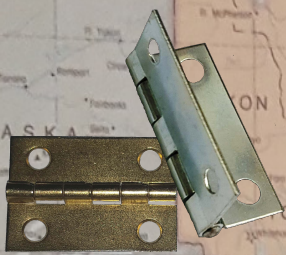
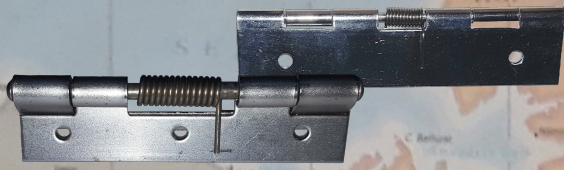

1-800-882-0120

nehinge@nehinge.com

www.nehinge.com



We can help with all your hinge needs!

Northeast Hinge

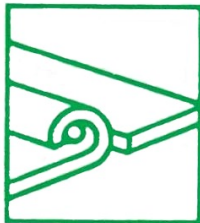

Distributors, Inc.

• HINGES •

Dear Hinge Buyer,

We would like to introduce you to Northeast Hinge Distributors, Inc. We are happy to show you our hinge catalog to assist you in specification, selection, or purchase of hinges.

If you find that the catalog does not provide you with an answer to your particular requirement, don't hesitate to give us a call. Our sales staff is ready to respond via Fax, Email, or by phone. Many companies are calling on us to service their requirement for all types of hinges because:

1. **Cost Competitiveness** - Our no minimum charge can save you money on those odd or special requirements. On large quantities we can offer very attractive pricing because of our association with over a dozen hinge manufacturers nation wide. Our Volume purchasing power enables us to pass on significant savings on you.
2. **Service** - We surpass our competitors in this area. We will react promptly to your design questions, requests for quotes and expedite requests. Most items in stock are shipped within 24 hours: those not are shipped when promised. We have the capability to provide factory and in-house secondary operations (cutting, hole punching, plating, laser cutting, etc.) If desired.
3. **Specials** - Many people think their requirement may be "Special" or hard-to-get item. Chances are it isn't. Send us your sample or print and we'll get back to you promptly with a quote or cost- saving alternative.
4. **Fast Turn Around** - Certain Specials can be done within a 2 week lead time. Please call or email your prints & requirements.

Let us prove that we are what we claim to be - # 1 in New England for all types of hinges.

**Drawings shown In this catalog are not to actual scale.*



Toll Free: **1-800-882-0120**
or (603) 465-3244
FAX: (603) 465-3313
P.O. Box 891, 261 Proctor Hill Road, Hollis, NH 03049
Email: nehinge@nehinge.com
www.nehinge.com

Hinge Terminology

Width

The overall dimension of a hinge edge to edge, opened to flat position, across the knuckle. LEAF WIDTH is measured from the center of the pin to the outer edge of the leaf.

Pitch

The overall length of two adjacent knuckles.

Knuckle Length

The nominal or typical dimension of a knuckle. The exact knuckle length is slightly less than the nominal dimension, and the space in the opposite leaf is slightly over this dimension. This allows for ease of rotation without excessive play.

Width Restrictions

In determining the maximum width of a given leaf in a hinge, the maximum hinge width must be divided by 2.

Length

The dimension of a hinge measured along the pin.

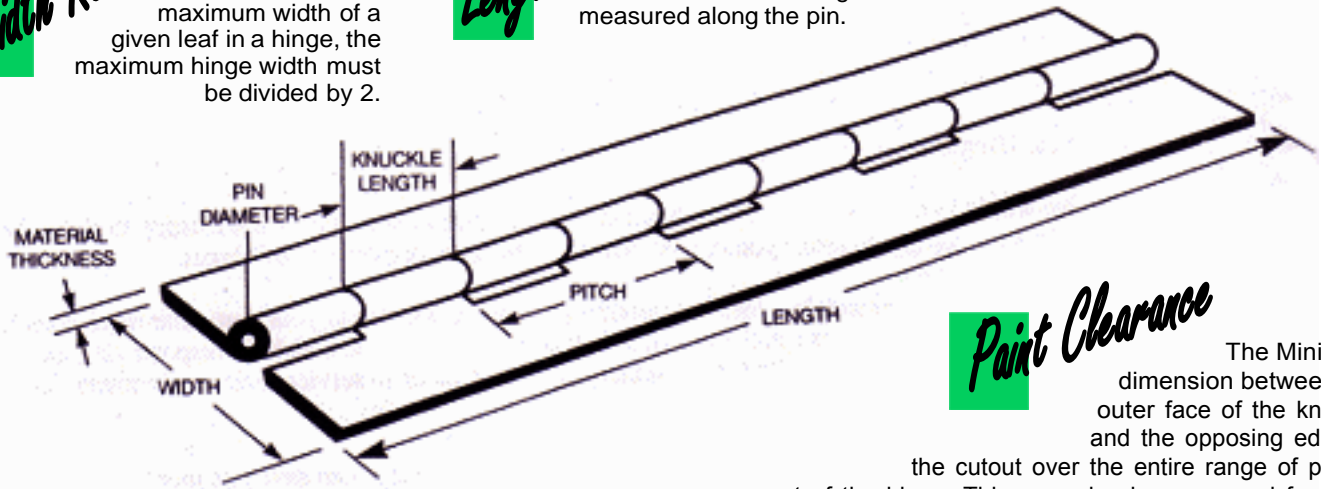

Paint Clearance

The Minimum dimension between the outer face of the knuckle and the opposing edge of the cutout over the entire range of pivotal movement of the hinge. This may also be measured from the center line of the pin to the cutout in the opposite leaf

Types of Leaves



PLAIN TYPES - NOT SWAGED

- Barrel sets above leaves which are flat or horizontal when opened



SWAGING - A Method of forming either or both leaves up to, or beyond, the center of the pin.



ONE LEAF HALF SWAGED - Where only one leaf is formed up to one half the pin diameter



ONE LEAF FULL SWAGED - Where one leaf is formed around to the full pin diameter. When closed both leaves are parallel.

Stop Hinge - Unit is fabricated to permit leaf travel only to an arc, or angle, specified.

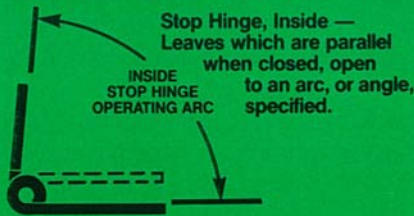

Stop Hinge, Inside - Leaves which are parallel when closed, open to an arc, or angle, specified.

Stop Hinge, Outside - Leaves which are in a flat plane when open, close to an arc, or angle, specified.

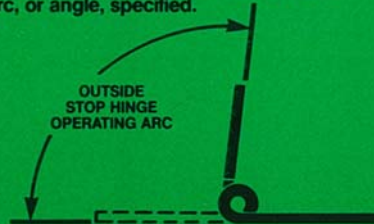

REVERSE SWAGE - Where one leaf is formed with the effect of reverse hinge assembly. Leaves cannot be closed to lay parallel.



OFFSET - Where either or both leaves are formed away from the outside of the pin. When closed in parallel position, the distance between the leaves measures larger than diameter of the pin.



BOTH LEAVES HALF SWAGED - Each leaf is formed to one half the pin diameter leaving minimum clearance between them when closed.

Aluminum Lengths

CONTINUOUS HINGES

MILL FINISH

EQUAL LEAVES- FULL HARD ALUMINUM PIN

(Unless Otherwise Specified)

STOCK LENGTHS 72" AND 96"

| STOCK NO. | THICKNESS | GAUGE | OPEN WIDTH | PIN DIA. | KNUCKLE LENGTH |
|-------------|-----------|-------|------------|----------|----------------|
| A021007510 | .025 | 24 | 3/4 | 1/16 | 1/4 |
| A021010610 | .025 | 24 | 1-1/16 | 1/16 | 1/4 |
| A021010010 | .025 | 24 | 1 | 1/16 | 1/4 |
| A031007520 | .032 | 20 | 3/4 | 1/16 | 1/2 |
| A031010020 | .032 | 20 | 1 | 1/16 | 1/2 |
| A031012520 | .032 | 20 | 1-1/4 | 1/16 | 1/2 |
| A031015020 | .032 | 20 | 1-1/2 | 1/16 | 1/2 |
| A033007510 | .032 | 20 | 3/4 | .086 | 1/4 |
| A033010610 | .032 | 20 | 1-1/16 | .086 | 1/4 |
| A033012510 | .032 | 20 | 1-1/4 | .086 | 1/4 |
| A033015010 | .032 | 20 | 1-1/2 | .086 | 1/4 |
| A044010620 | .040 | 19 | 1-1/16 | .091 | 1/2 |
| AC044010620 | .040 | 19 | 1-1/16 | .091SS | 1/2 |
| A044012520 | .040 | 19 | 1-1/4 | .091 | 1/2 |
| A044015020 | .040 | 19 | 1-1/2 | .091 | 1/2 |
| A044015030 | .040 | 19 | 1-1/2 | .091 | 5/8 |
| A044020020 | .040 | 19 | 2 | .091 | 1/2 |
| AC044020020 | .040 | 19 | 2 | .091SS | 1/2 |
| A042015010 | .040 | 19 | 1-1/2 | .080 | 1/4 |
| A042010610 | .040 | 19 | 1-1/16 | .080 | 1/4 |
| A044010630 | .040 | 19 | 1-1/16 | .091 | 5/8 |
| A044012530 | .040 | 19 | 1-1/4 | .091 | 5/8 |
| A055012520 | .050 | 18 | 1-1/4 | 1/8 | 1/2 |
| A055015020 | .050 | 18 | 1-1/2 | 1/8 | 1/2 |
| A055020020 | .050 | 18 | 2 | 1/8 | 1/2 |
| A055030020 | .050 | 18 | 3 | 1/8 | 1/2 |
| A055015030 | .050 | 18 | 1-1/2 | 1/8 | 5/8 |
| A065010630 | .062 | 16 | 1-1/16 | 1/8 | 5/8 |
| A065010620 | .062 | 16 | 1-1/16 | 1/8 | 1/2 |
| A065012530 | .062 | 16 | 1-1/4 | 1/8 | 5/8 |
| A065012520 | .062 | 16 | 1-1/4 | 1/8 | 1/2 |
| A065015020 | .062 | 16 | 1-1/2 | 1/8 | 1/2 |
| A065015030 | .062 | 16 | 1-1/2 | 1/8 | 5/8 |
| A065020020 | .062 | 16 | 2 | 1/8 | 1/2 |
| A065025020 | .062 | 16 | 2-1/2 | 1/8 | 1/2 |
| AC065025020 | .062 | 16 | 2-1/2 | 1/8SS | 1/2 |
| A065030020 | .062 | 16 | 3 | 1/8 | 1/2 |
| A065035020 | .062 | 16 | 3-1/2 | 1/8 | 1/2 |
| A065040020 | .062 | 16 | 4 | 1/8 | 1/2 |
| AC065010620 | .062 | 16 | 1-1/16 | 1/8SS | 1/2 |
| A065012550 | .062 | 16 | 1-1/4 | 1/8 | 1 |

| STOCK NO. | THICKNESS | GAUGE | OPEN WIDTH | PIN DIA. | KNUCKLE LENGTH |
|-------------|-----------|-------|------------|----------|----------------|
| A065015050 | .062 | 16 | 1-1/2 | 1/8 | 1 |
| A065020050 | .062 | 16 | 2 | 1/8 | 1 |
| AC065025050 | .062 | 16 | 2-1/2 | 1/8SS | 1 |
| A066015020 | .062 | 16 | 1-1/2 | 3/16 | 1/2 |
| A066020020 | .062 | 16 | 2 | 3/16 | 1/2 |
| A066025020 | .062 | 16 | 2-1/2 | 3/16 | 1/2 |
| A066030020 | .062 | 16 | 3 | 3/16 | 1/2 |
| A066035020 | .062 | 16 | 3-1/2 | 3/16 | 1/2 |
| A066040020 | .062 | 16 | 4 | 3/16 | 1/2 |
| AC065012530 | .062 | 16 | 1-1/4 | 1/8SS | 5/8 |
| AC065015030 | .062 | 16 | 1-1/2 | 1/8SS | 5/8 |
| A076020020 | .075 | 14 | 2 | 3/16 | 1/2 |
| A076025020 | .075 | 14 | 2-1/2 | 3/16 | 1/2 |
| A076030020 | .075 | 14 | 3 | 3/16 | 1/2 |
| A076035020 | .075 | 14 | 3-1/2 | 3/16 | 1/2 |
| A076040020 | .075 | 14 | 4 | 3/16 | 1/2 |
| A097020050 | .093 | 13 | 2 | 1/4 | 1 |
| A097025050 | .093 | 13 | 2-1/2 | 1/4 | 1 |
| A097030050 | .093 | 13 | 3 | 1/4 | 1 |
| A097040050 | .093 | 13 | 4 | 1/4 | 1 |
| A127020060 | .120 | 11 | 2 | 1/4 | 2 |
| A127025060 | .120 | 11 | 2-1/2 | 1/4 | 2 |
| A127030060 | .120 | 11 | 3 | 1/4 | 2 |
| A127040060 | .120 | 11 | 4 | 1/4 | 2 |
| A127050060 | .120 | 11 | 5 | 1/4 | 2 |
| A128020060 | .120 | 11 | 2 | 3/8 | 2 |
| A128030060 | .120 | 11 | 3 | 3/8 | 2 |
| A128040060 | .120 | 11 | 4 | 3/8 | 2 |
| A128050060 | .120 | 11 | 5 | 3/8 | 2 |
| A128060060 | .120 | 11 | 6 | 3/8 | 2 |

*SS = Stainless Steel Pin



Unplated Steel Lengths

CONTINUOUS HINGES

EQUAL LEAVES - STEEL PINS

STOCK LENGTHS 72" AND 96"

| STOCK NO. | THICKNESS | GAUGE | OPEN WIDTH | PIN DIA. | KNUCKLE LENGTH |
|------------|-----------|-------|------------|----------|----------------|
| S076015050 | .075 | 14 | 1-1/2 | 3/16 | 1 |
| S076020050 | .075 | 14 | 2 | 3/16 | 1 |
| S076025050 | .075 | 14 | 2-1/2 | 3/16 | 1 |
| S076030050 | .075 | 14 | 3 | 3/16 | 1 |
| S076035050 | .075 | 14 | 3-1/2 | 3/16 | 1 |
| S076040050 | .075 | 14 | 4 | 3/16 | 1 |
| S076020060 | .075 | 14 | 2 | 3/16 | 2 |
| S076030060 | .075 | 14 | 3 | 3/16 | 2 |
| S076025060 | .075 | 14 | 2-1/2 | 3/16 | 2 |
| S077015050 | .075 | 14 | 1-1/2 | 1/4 | 1 |
| S077020050 | .075 | 14 | 2 | 1/4 | 1 |
| S077025050 | .075 | 14 | 2-1/2 | 1/4 | 1 |
| S077030050 | .075 | 14 | 3 | 1/4 | 1 |
| S077035050 | .075 | 14 | 3-1/2 | 1/4 | 1 |
| S077040050 | .075 | 14 | 4 | 1/4 | 1 |
| S077020060 | .075 | 14 | 2 | 1/4 | 2 |
| S077025060 | .075 | 14 | 2-1/2 | 1/4 | 2 |
| S077030060 | .075 | 14 | 3 | 1/4 | 2 |
| S077035060 | .075 | 14 | 3-1/2 | 1/4 | 2 |
| S077040060 | .075 | 14 | 4 | 1/4 | 2 |
| S077050060 | .075 | 14 | 5 | 1/4 | 2 |
| S097020050 | .093 | 13 | 2 | 1/4 | 1 |
| S097030050 | .093 | 13 | 3 | 1/4 | 1 |
| S097040050 | .093 | 13 | 4 | 1/4 | 1 |
| S097020060 | .093 | 13 | 2 | 1/4 | 2 |
| S097030060 | .093 | 13 | 3 | 1/4 | 2 |
| S097035060 | .093 | 13 | 3-1/2 | 1/4 | 2 |
| S097040060 | .093 | 13 | 4 | 1/4 | 2 |
| S097050060 | .093 | 13 | 5 | 1/4 | 2 |
| S127020060 | .120 | 11 | 2 | 1/4 | 2 |
| S127030060 | .120 | 11 | 3 | 1/4 | 2 |
| S127040060 | .120 | 11 | 4 | 1/4 | 2 |
| S127025060 | .120 | 11 | 2-1/2 | 1/4 | 2 |
| S127050060 | .120 | 11 | 5 | 1/4 | 2 |

| STOCK NO. | THICKNESS | GAUGE | OPEN WIDTH | PIN DIA. | KNUCKLE LENGTH |
|------------|-----------|-------|------------|----------|----------------|
| S128025060 | .120 | 11 | 2-1/2 | 3/8 | 2 |
| S128020060 | .120 | 11 | 2 | 3/8 | 2 |
| S128030060 | .120 | 11 | 3 | 3/8 | 2 |
| S128035060 | .120 | 11 | 3-1/2 | 3/8 | 2 |
| S128040060 | .120 | 11 | 4 | 3/8 | 2 |
| S128050060 | .120 | 11 | 5 | 3/8 | 2 |
| S128060060 | .120 | 11 | 6 | 3/8 | 2 |
| S128080060 | .120 | 11 | 8 | 3/8 | 2 |
| S128025060 | .120 | 11 | 2-1/2 | 3/8 | 2 |
| S189030060 | .180 | 7 | 3 | 1/2 | 2 |
| S189040060 | .180 | 7 | 4 | 1/2 | 2 |
| S189050060 | .180 | 7 | 5 | 1/2 | 2 |
| S189060060 | .180 | 7 | 6 | 1/2 | 2 |
| S189080060 | .180 | 7 | 8 | 1/2 | 2 |



Updated Steel Lengths

CONTINUOUS HINGES

EQUAL LEAVES - STEEL PINS

STOCK LENGTHS 72" AND 96"

| STOCK NO. | THICKNESS | GAUGE | OPEN WIDTH | PIN DIA. | KNUCKLE LENGTH |
|------------|-----------|-------|------------|----------|----------------|
| S021010010 | .025 | 24 | 1 | 1/16 | 1/4 |
| S021015010 | .025 | 24 | 1-1/2 | 1/16 | 1/4 |
| S021007510 | .025 | 24 | 3/4 | 1/16 | 1/4 |
| S031010020 | .035 | 20 | 1 | 1/16 | 1/2 |
| S031007520 | .035 | 20 | 3/4 | 1/16 | 1/2 |
| S031010620 | .035 | 20 | 1-1/16 | 1/16 | 1/2 |
| S031012520 | .035 | 20 | 1-1/4 | 1/16 | 1/2 |
| S031015020 | .035 | 20 | 1-1/2 | 1/16 | 1/2 |
| S034010010 | .035 | 20 | 1 | .091 | 1/2 |
| S033007510 | .035 | 20 | 3/4 | .086 | 1/4 |
| S033010610 | .035 | 20 | 1-1/16 | .086 | 1/4 |
| S103312510 | .035 | 20 | 1-1/4 | .086 | 1/4 |
| S033015010 | .035 | 20 | 1-1/2 | .086 | 1/4 |
| S033020010 | .035 | 20 | 2 | .086 | 1/4 |
| S042010010 | .040 | 19 | 1 | .080 | 1/4 |
| S044010620 | .040 | 19 | 1-1/16 | .091 | 1/2 |
| S044012520 | .040 | 19 | 1-1/4 | .091 | 1/2 |
| S044015020 | .040 | 19 | 1-1/2 | .091 | 1/2 |
| S044020020 | .040 | 19 | 2 | .091 | 1/2 |
| S044025020 | .040 | 19 | 2-1/2 | .091 | 1/2 |
| S055010620 | .050 | 18 | 1-1/16 | 1/8 | 1/2 |
| S055012520 | .050 | 18 | 1-1/4 | 1/8 | 1/2 |
| S055015020 | .050 | 18 | 1-1/2 | 1/8 | 1/2 |
| S055010630 | .050 | 18 | 1-1/16 | 1/8 | 5/8 |
| S055020020 | .050 | 18 | 2 | 1/8 | 1/2 |
| S055025020 | .050 | 18 | 2-1/2 | 1/8 | 1/2 |
| S055030020 | .050 | 18 | 3 | 1/8 | 1/2 |
| S055012530 | .050 | 18 | 1-1/4 | 1/8 | 5/8 |
| S055015030 | .050 | 18 | 1-1/2 | 1/8 | 5/8 |
| S065010620 | .062 | 16 | 1-1/16 | 1/8 | 1/2 |
| S065012520 | .062 | 16 | 1-1/4 | 1/8 | 1/2 |
| S065015030 | .062 | 16 | 1-1/2 | 1/8 | 5/8 |
| S065015020 | .062 | 16 | 1-1/2 | 1/8 | 1/2 |
| S065020020 | .062 | 16 | 2 | 1/8 | 1/2 |
| S065025020 | .062 | 16 | 2-1/2 | 1/8 | 1/2 |
| S065030020 | .062 | 16 | 3 | 1/8 | 1/2 |

| STOCK NO. | THICKNESS | GAUGE | OPEN WIDTH | PIN DIA. | KNUCKLE LENGTH |
|------------|-----------|-------|------------|----------|----------------|
| S065035020 | .062 | 16 | 3-1/2 | 1/8 | 1/2 |
| S065040020 | .062 | 16 | 4 | 1/8 | 1/2 |
| S065017520 | .062 | 16 | 1-3/4 | 1/8 | 1/2 |
| S065012530 | .062 | 16 | 1-1/4 | 1/8 | 5/8 |
| S065020030 | .062 | 16 | 2 | 1/8 | 5/8 |
| S065010650 | .062 | 16 | 1-1/16 | 1/8 | 1 |
| S065012550 | .062 | 16 | 1-1/4 | 1/8 | 1 |
| S065015050 | .062 | 16 | 1-1/2 | 1/8 | 1 |
| S065020050 | .062 | 16 | 2 | 1/8 | 1 |
| S065025050 | .062 | 16 | 2-1/2 | 1/8 | 1 |
| S065030050 | .062 | 16 | 3 | 1/8 | 1 |
| S065035050 | .062 | 16 | 3-1/2 | 1/8 | 1 |
| S065040050 | .062 | 16 | 4 | 1/8 | 1 |
| S066015050 | .062 | 16 | 1-1/2 | 3/16 | 1 |
| S066020050 | .062 | 16 | 2 | 3/16 | 1 |
| S066025050 | .062 | 16 | 2-1/2 | 3/16 | 1 |
| S066030050 | .062 | 16 | 3 | 3/16 | 1 |
| S066035050 | .062 | 16 | 3-1/2 | 3/16 | 1 |
| S066040050 | .062 | 16 | 4 | 3/16 | 1 |
| S066015020 | .062 | 16 | 1-1/2 | 3/16 | 1/2 |
| S066020020 | .062 | 16 | 2 | 3/16 | 1/2 |
| S066025020 | .062 | 16 | 2-1/2 | 3/16 | 1/2 |
| S066030020 | .062 | 16 | 3 | 3/16 | 1/2 |
| S066035020 | .062 | 16 | 3-1/2 | 3/16 | 1/2 |
| S066040020 | .062 | 16 | 4 | 3/16 | 1/2 |
| S066020060 | .062 | 16 | 2 | 3/16 | 2 |
| S066025060 | .062 | 16 | 2-1/2 | 3/16 | 2 |
| S066030060 | .062 | 16 | 3 | 3/16 | 2 |
| S066040060 | .062 | 16 | 4 | 3/16 | 2 |

We are able to produce special and fabricated hinges. Operations such as *hole punching, forming, offsetting, notching, countersinking, etc.* Please call us with your special requirements.



Stainless Lengths

CONTINUOUS HINGES

2-B MILL FINISH·TYPE 304 STAINLESS STEEL
EQUAL LEAVES- STAINLESS STEEL PINS

STOCK LENGTHS 72" AND 96"

| STOCK NO. | THICKNESS | GAUGE | OPEN WIDTH | PIN DIA. | KNUCKLE LENGTH |
|------------|-----------|-------|------------|----------|----------------|
| C021010010 | .025 | 24 | 1 | 1/16 | 1/4 |
| C021007510 | .025 | 24 | 3/4 | 1/16 | 1/4 |
| C031010010 | .035 | 20 | 1 | 1/16 | 1/4 |
| C031012520 | .035 | 20 | 1-1/4 | 1/16 | 1/2 |
| C031015020 | .035 | 20 | 1-1/2 | 1/16 | 1/2 |
| C033007510 | .035 | 20 | 3/4 | .086 | 1/4 |
| C033010610 | .035 | 20 | 1-1/16 | .086 | 1/4 |
| C033012510 | .035 | 20 | 1-1/4 | .086 | 1/4 |
| C033015010 | .035 | 20 | 1-1/2 | .086 | 1/4 |
| C044010620 | .040 | 19 | 1-1/16 | .091 | 1/2 |
| C044012520 | .040 | 19 | 1-1/4 | .091 | 1/2 |
| C044015020 | .040 | 19 | 1-1/2 | .091 | 1/2 |
| C044020020 | .040 | 19 | 2 | .091 | 1/2 |
| C044010630 | .040 | 19 | 1-1/16 | .091 | 5/8 |
| C044012530 | .040 | 19 | 1-1/4 | .091 | 5/8 |
| C044015030 | .040 | 19 | 1-1/2 | .091 | 5/8 |
| C055012520 | .050 | 18 | 1-1/4 | 1/8 | 1/2 |
| C055015020 | .050 | 18 | 1-1/2 | 1/8 | 1/2 |
| C055020020 | .050 | 18 | 2 | 1/8 | 1/2 |
| C055012530 | .050 | 18 | 1-1/4 | 1/8 | 5/8 |
| C065010620 | .062 | 16 | 1-1/16 | 1/8 | 1/2 |
| C065012520 | .062 | 16 | 1-1/4 | 1/8 | 1/2 |
| C065015020 | .062 | 16 | 1-1/2 | 1/8 | 1/2 |
| C065020020 | .062 | 16 | 2 | 1/8 | 1/2 |
| C065025020 | .062 | 16 | 2-1/2 | 1/8 | 1/2 |
| C065030020 | .062 | 16 | 3 | 1/8 | 1/2 |
| C065010630 | .062 | 16 | 1-1/16 | 1/8 | 5/8 |
| C065015050 | .062 | 16 | 1-1/2 | 1/8 | 1 |
| C065020050 | .062 | 16 | 2 | 1/8 | 1 |
| C065025050 | .062 | 16 | 2-1/2 | 1/8 | 1 |
| C066020030 | .062 | 16 | 2 | 3/16 | 5/8 |
| C066015020 | .062 | 16 | 1-1/2 | 3/16 | 1/2 |
| C066020020 | .062 | 16 | 2 | 3/16 | 1/2 |
| C066025020 | .062 | 16 | 2-1/2 | 3/16 | 1/2 |
| C066030020 | .062 | 16 | 3 | 3/16 | 1/2 |
| C066015050 | .062 | 16 | 1-1/2 | 3/16 | 1 |
| C066020050 | .062 | 16 | 2 | 3/16 | 1 |
| C066025050 | .062 | 16 | 2-1/2 | 3/16 | 1 |
| C076020050 | .075 | 14 | 2 | 3/16 | 1 |
| C076025050 | .075 | 14 | 2-1/2 | 3/16 | 1 |

| STOCK NO. | THICKNESS | GAUGE | OPEN WIDTH | PIN DIA. | KNUCKLE LENGTH |
|------------|-----------|-------|------------|----------|----------------|
| C076030050 | .075 | 14 | 3 | 3/16 | 1 |
| C076040050 | .075 | 14 | 4 | 3/16 | 1 |
| C076040060 | .075 | 14 | 4 | 3/16 | 2 |
| C077020050 | .075 | 14 | 2 | 1/4 | 1 |
| C077025050 | .075 | 14 | 2-1/2 | 1/4 | 1 |
| C077030050 | .075 | 14 | 3 | 1/4 | 1 |
| C077040050 | .075 | 14 | 4 | 1/4 | 1 |
| C077020060 | .075 | 14 | 2 | 1/4 | 2 |
| C077030060 | .075 | 14 | 3 | 1/4 | 2 |
| C077040060 | .075 | 14 | 4 | 1/4 | 2 |
| C007750060 | .075 | 14 | 5 | 1/4 | 2 |
| C097020050 | .093 | 13 | 2 | 1/4 | 1 |
| C097030050 | .093 | 13 | 3 | 1/4 | 1 |
| C097040050 | .093 | 13 | 4 | 1/4 | 1 |
| C096040060 | .093 | 13 | 4 | 3/16 | 2 |
| C127020060 | .120 | 11 | 2 | 1/4 | 2 |
| C127030060 | .120 | 11 | 3 | 1/4 | 2 |
| C127040060 | .120 | 11 | 4 | 1/4 | 2 |
| C128020060 | .120 | 11 | 2 | 3/8 | 2 |
| C128030060 | .120 | 11 | 3 | 3/8 | 2 |
| C128040060 | .120 | 11 | 4 | 3/8 | 2 |
| C128050060 | .120 | 11 | 5 | 3/8 | 2 |

The hinges listed are the most heavily stocked and of the highest usage. Many other sizes are available which are not listed above. If you do not see the item you require listed -*just ask us!*

TYPE 316 SS CONTINUOUS HINGES

| STOCK NO. | THICKNESS | GAUGE | OPEN WIDTH | PIN DIA. | KNUCKLE LENGTH |
|-------------|-----------|-------|------------|----------|----------------|
| CT044010620 | .040 | 19 | 1-1/16 | .091 | 1/2 |
| CT044015020 | .040 | 19 | 1-1/2 | .091 | 1/2 |
| CT044020020 | .040 | 19 | 2 | .091 | 1/2 |
| CT065015020 | .060 | 16 | 1-1/2 | 1/8 | 1/2 |
| CT065020020 | .060 | 16 | 2 | 1/8 | 1/2 |
| CT065030020 | .060 | 16 | 3 | 1/8 | 1/2 |
| CT128030060 | .060 | 11 | 3 | 3/8 | 2 |



Pre-Plated

CONTINUOUS HINGES

EQUAL LEAVES
STOCK WITH HOLES
(2 Inch on Center)

Brass Plated with Holes

| STOCK NO. | THICKNESS | GAUGE | OPEN WIDTH | PIN DIA. | KNUCKLE LENGTH | LENGTH |
|-----------------|-----------|-------|------------|----------|----------------|--------|
| PB031007510-72H | .032 | 20 | 3/4 | .062 | 1/4 | 72 in. |
| PB044010620-72H | .040 | 19 | 1-1/16 | .091 | 1/2 | 72 in. |
| PB044012520-72H | .040 | 19 | 1-1/4 | .091 | 1/2 | 72 in. |
| PB044015020-72H | .040 | 19 | 1-1/2 | .091 | 1/2 | 72 in. |
| PB044020020-72H | .040 | 19 | 2 | .091 | 1/2 | 72 in. |
| PB044020020-96H | .040 | 19 | 2 | .091 | 1/2 | 96 in. |

Nickel Plated with Holes

| STOCK NO. | THICKNESS | GAUGE | OPEN WIDTH | PIN DIA. | KNUCKLE LENGTH | LENGTH |
|-----------------|-----------|-------|------------|----------|----------------|--------|
| PN044010620-72H | .040 | 19 | 1-1/16 | .091 | 1/2 | 72 in. |
| PN044012520-72H | .040 | 19 | 1-1/4 | .091 | 1/2 | 72 in. |
| PN044015020-72H | .040 | 19 | 1-1/2 | .091 | 1/2 | 72 in. |
| PN044015020-48H | .040 | 19 | 1-1/2 | .091 | 1/2 | 48 in. |
| PN044015020-96H | .040 | 19 | 1-1/2 | .091 | 1/2 | 96 in. |
| PN044020020-72H | .040 | 19 | 2 | .091 | 1/2 | 72 in. |
| PN044020020-96H | .040 | 19 | 2 | .091 | 1/2 | 96 in. |
| PN065012520-72H | .062 | 16 | 1-1/4 | .120 | 1/2 | 72 in. |
| PN065020020-72H | .062 | 16 | 2 | .120 | 1/2 | 72 in. |
| PN065030020-72H | .062 | 16 | 3 | .120 | 1/2 | 72 in. |

The above listing is representative of our normal stock pre-plated hinges.

Stainless Steel with Holes

| STOCK NO. | THICKNESS | GAUGE | OPEN WIDTH | PIN DIA. | KNUCKLE LENGTH | LENGTH |
|----------------|-----------|-------|------------|----------|----------------|--------|
| C044010620-72H | .040 | 19 | 1-1/16 | .091 | 1/2 | 72 in. |
| C044012520-72H | .040 | 19 | 1-1/4 | .091 | 1/2 | 72 in. |
| C044015020-72H | .040 | 19 | 1-1/2 | .091 | 1/2 | 72 in. |
| C044020020-72H | .040 | 19 | 2 | .091 | 1/2 | 72 in. |
| C065015020-72H | .062 | 16 | 1-1/2 | .120 | 1/2 | 72 in. |
| C065015020-96H | .062 | 16 | 1-1/2 | .120 | 1/2 | 96 in. |
| C065020020-72H | .062 | 16 | 2 | .120 | 1/2 | 72 in. |

Any other length and perforating patterns available upon request.

Military Hinges

MS20253 and A-A-55486 Hinge Pins For MS20257 and MS20001 Series Continuous Hinges

| Dash No. | | |
|----------------|------------|----------|
| Cadmium Plated | Passivated | Diameter |
| -P1 | -1 | .062 |
| -P2 | -2 | .089 |
| -P3 | -3 | .117 |
| -P4 | -4 | .179 |
| -P5 | -5 | .129 |

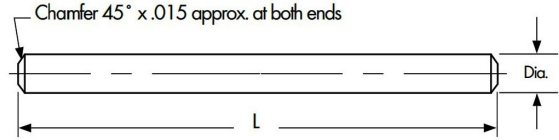

Use Cadmium Plated Corrosion Resistant Steel with Aluminum Alloy Hinge.
Use Passivated Corrosion Resistant Steel Pin with Corrosion Resistant Steel Hinge.

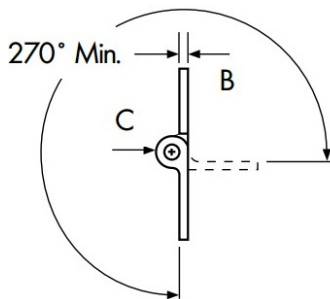
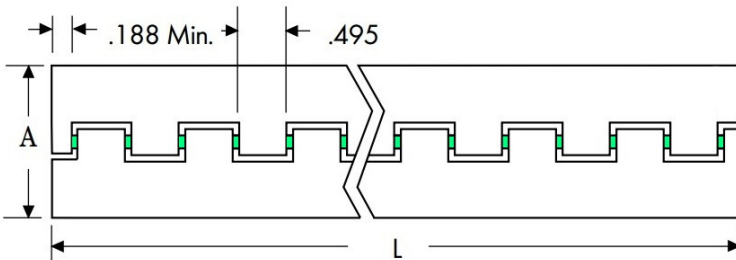

MS20001 SERIES CONTINUOUS HINGES Type 2024-T3511 Extruded Aluminum

| DASH NO. | B-Leaf Thickness | | | PIN DIA. |
|----------|------------------|---------|---------|----------|
| | A | MAXIMUM | MINIMUM | |
| -2 | 1.062 | .056 | .044 | .090 |
| -3 | 1.250 | .056 | .044 | .090 |
| -4 | 1.500 | .056 | .044 | .090 |
| -5 | 1.750 | .056 | .044 | .090 |
| -6 | 2.000 | .056 | .044 | .090 |
| -8 | 2.000 | .076 | .044 | .180 |
| -9 | 2.500 | .056 | .044 | .090 |
| -10 | 2.750 | .056 | .044 | .090 |
| -12 | 3.375 | .115 | .103 | .090 |
| -14 | 3.719 | .163 | .149 | .129 |
| -16 | 3.938 | .210 | .196 | .180 |

SPECIFY

*P = Anodized per Mal-A-8625, Type II

*C = Alodine per Mil-DTL-5541

*A = Aluminum Alloy 7075-T 73511

Military Hinges

GOVERNMENT SPECIFICATIONS

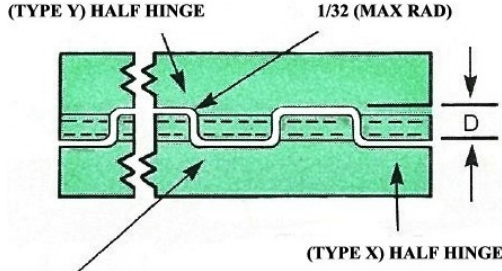

Impress "MS-20257Size Dash No." at regular intervals along length of hinge so that any three inch length will have at least one complete identification in figures not less than .06 inch high. Depressed figures shall not exceed .010 inch in depth. Designation for anodizing and for length shall not be included in marking.

MILITARY STANDARDS

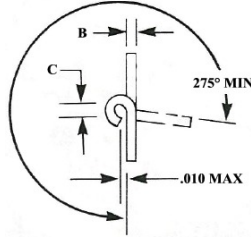

WHOLE HINGES SUPPLIED WITH PINS. HALF HINGES SUPPLIED WITHOUT PINS

MS-20257 SPECIFICATION/ SUPERSEDES AN-257

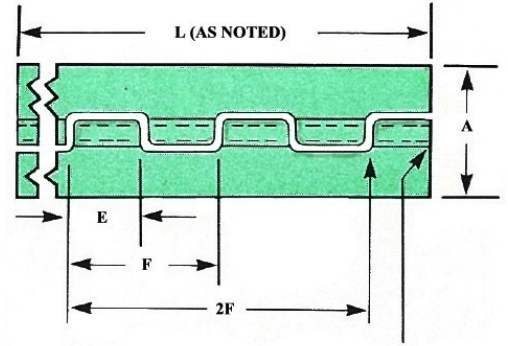

(TYPE H) Half Hinge
Loop shall be on RH end of half hinge as shown

MS20257 SERIES CONTINUOUS HINGES

| DASH NO. | | A | | B | | C | | D | | E | F | Pin Diameter |
|----------------|----------|----------------|------------|----------------|----------------|---------------|----------------|-------------|----------------|-------|-------|----------------|
| Aluminum Alloy | | Open Width | | Leaf Thickness | | Hole Diameter | | Slot Depth | | Loop | Pitch | Cor. Res Steel |
| Unanodized | Anodized | Cor. Res Steel | Open Width | Alum. Alloy | Cor. Res Steel | Alum. Alloy | Cor. Res Steel | Alum. Alloy | Cor. Res Steel | Loop | Pitch | Cor. Res Steel |
| 1 | P1 | C1 | .75 | .032 | .031 | .066 | .066 | .169 | .166 | .490 | 1.000 | .063 |
| 2 | P2 | C2 | 1.06 | .040 | .037 | .093 | .093 | .220 | .211 | .490 | 1.000 | .090 |
| 3 | P3 | C3 | 1.25 | .040 | .050 | .093 | .121 | .220 | .278 | .490 | 1.000 | .118 |
| 4 | P4 | C4 | 1.50 | .040 | .062 | .093 | .121 | .220 | .314 | .490 | 1.000 | .118 |
| 5 | P5 | C5 | 2.00 | .051 | .062 | .093 | .183 | .253 | .376 | .490 | 1.000 | .180 |
| 6 | P6 | C6 | 2.00 | .064 | .062 | .183 | .183 | .382 | .376 | 1.990 | 4.047 | .180 |

All MS20557 Series Stock Lengths are 72 Inches Long

- (a) Complete Hinges are furnished with a pin of the same length.
- (b) Second dash number indicates length (L) expressed in inches and hundredths not exceeding stock length of table. End loops and/or tangs must never exceed a full loop or tang, and both ends must equal within .020 inch.
- (c) Tolerance shall be $\pm .008$ on each dimension for F, 2F, 3F, etc. and shall not be cumulative.
- (d) Types X and Y Half Hinges can be made from Type H Half Hinge but will not be stocked or procured by service activities.
- (e) Hinge pins shall be in accordance with MS20253. Use Cadmium Plated Corrosion Resistant Steel Pin and Aluminum Alloy Hinge. Use Passivated Corrosion Resistant Steel Pin with Corrosion Resistant Steel Hinge.

MATERIAL

Aluminum Alloy, 5052, H24 or H34 per QQ-A-250/8.
Corrosion Resistant Steel per QQ-s-766, type 301, 302, or 304.

FINISH

Aluminum Alloy, Anodized. MIL-A-8625t, type II or none depending on coding.
Corrosion Resistant Steel, none.

Remove all burrs and sharp edges. Dimensions in inches, unless otherwise specified, tolerances: decimals $\pm .010$, angles $\pm 1/2^\circ$, Add H, X, or Y before first dash number for Half Hinge without Pin.



Military Hinges

SPECIFICATIONS: GOVERNMENT STANDARDS/MILITARY STANDARDS

| MS-35000 SERIES CONTINUOUS HINGES | | | | | | | | | | | | | | | | | | | | | | |
|-----------------------------------|-----------|---------|----------|--------|------------|----|----|----|------|-----|----|------|------|------|-----|-----|-----|-----|-----|-----|-----|-----|
| Stock No. | Thickness | Knuckle | Pin Dia. | Length | Open Width | | | | | | | | | | | | | | | | | |
| | | | | | -1 | -2 | -3 | -4 | -5 | -6 | -7 | -8 | -9 | -10 | -11 | -12 | -13 | -14 | -15 | -16 | -17 | -18 |
| MS-35821 | .032 | 1/2 | .063 | 72 | | | | | | .75 | 1 | 1.06 | 1.25 | 1.5 | | | | | | | | |
| MS-35822 | .040 | 1/2 | .091 | 72 | | | | | | | | | 1.06 | 1.25 | 1.5 | 2 | | | | | | |
| | .040 | 5/8 | .091 | 72 | | | | | | | | | | | | | | | 2 | | | |
| MS-35823 | .050 | 5/8 | .125 | 72 | | | | | 1.06 | 1.5 | 2 | 2.5 | | | | | | | | | | |
| MS-35825 | .060 | 5/8 | .125 | 84 | | | | | | | | | 1.06 | 1.5 | 2 | 2.5 | | | | | | |
| | .060 | 1 | .125 | 84 | | | | | | | | | | | | | | | 2 | | | |
| MS-35826 | .060 | 1 | .187 | 84 | | | | | | | | | 1.06 | 1.5 | 2 | 2.5 | | | | | | |
| | .060 | 2 | .187 | 84 | | | | | | | | | | | | | | | 2 | | | |
| MS-35829 | .075 | 2 | .187 | 84 | | | | | | | | | | | 2 | 2.5 | 3 | 3.5 | 4 | | | |
| | .075 | 2 | .250 | 84 | | | | | | | | | | | | | | | 2 | | 3 | 4 |
| MS-35830 | .090 | 2 | .250 | 84 | | | | | | | | | | | 3 | 3.5 | 4 | 5 | | | | |
| | .090 | 2 | .312 | * | | | | | | | | | | | | | | | | | | |
| | .090 | 2 | .375 | 84 | | | | | 4 | 5 | 6 | | | | | | | | | | | |
| MS-35831 | .125 | 2 | .312 | * | 4 | 5 | | | | | | | | | | | | | | | | |
| | .125 | 2 | .375 | 84 | | | | | | 4 | 5 | 6 | | | | | | | | | | |

These sizes are inactive for new design effective Jan. 22, 1976 but can be manufactured to your requirements.

| A-A-55000 SERIES CONTINUOUS HINGES | | | | | | | | | | | | | | | | | | | | | | |
|------------------------------------|-----------|---------|----------|--------|------------|----|----|----|------|-----|----|------|------|------|-----|-----|------|------|-----|-----|-----|-----|
| Stock No. | Thickness | Knuckle | Pin Dia. | Length | Open Width | | | | | | | | | | | | | | | | | |
| | | | | | -1 | -2 | -3 | -4 | -5 | -6 | -7 | -8 | -9 | -10 | -11 | -12 | -13 | -14 | -15 | -16 | -17 | -18 |
| A-A-55589 | .032 | .50 | .063 | 72 | | | | | | .75 | 1 | 1.06 | 1.25 | 1.5 | | | | | | | | |
| A-A-55590 | .040 | .50 | .091 | 72 | | | | | | | | | 1.06 | 1.25 | 1.5 | 2 | | | | | | |
| | .040 | .62 | .091 | 72.5 | | | | | | | | | | | | | 1.06 | 1.25 | 1.5 | 2 | | |
| A-A-55591 | .050 | .62 | .125 | 72.5 | | | | | 1.06 | 1.5 | 2 | 2.5 | | | | | | | | | | |
| A-A-55592 | .060 | .62 | .125 | 85 | | | | | | | | | 1.06 | 1.5 | 2 | 2.5 | | | | | | |
| | .060 | 1 | .125 | 84 | | | | | | | | | | | | | 1.06 | 1.5 | 2 | 2.5 | | |
| A-A-55593 | .060 | 1 | .187 | 84 | | | | | | | | | 1.06 | 1.5 | 2 | 2.5 | | | | | | |
| | .060 | 2 | .187 | 84 | | | | | | | | | | | | | 1.06 | 1.5 | 2 | 2.5 | | |
| A-A-55594 | .075 | 2 | .187 | 84 | | | | | | | | | | | 2 | 2.5 | 3 | 3.5 | 4 | | | |
| | .075 | 2 | .250 | 84 | | | | | | | | | | | | | | 2 | 2.5 | 3 | 3.5 | 4 |
| A-A-55595 | .090 | 2 | .250 | 84 | | | | | | | | | | | 3 | 3.5 | 4 | 5 | | | | |
| | .090 | 2 | .312 | * | | | | | 4 | 5 | 6 | | | | | | | | | | | |
| | .090 | 2 | .375 | 84 | | | | | | | | | | | | | | | | | | |
| A-A-55596 | .125 | 2 | .312 | * | 4 | 5 | | | | | | | | | | | | | | | | |
| | .125 | 2 | .375 | 84 | | | | | | 4 | 5 | 6 | | | | | | | | | | |

NOTES:

MATERIAL:

- A. Aluminum-Leaf-Temper H24 or H34 half hard, per QQ-A-250/8.
- Aluminum-Pin -Temper, half hard per QQ-A-225/7.
- B. Brass-Leaf-Alloy 268. temper half hard, per QQ-B-613.
- Copper-Pin-Alloy 260. temper half hard per QQ-W-321.
- C. Corrosion Resisting Steel-Leaf Class 301, 302, or 304. Condition A temper annealed, per QQ-S-766.
- Corrosion Resisting Steel-Pin-Form 1, Condition B, per QQ-W-423.
- D. Carbon Steel-Leaf-Cold-rolled, temper No. 4, per QQ-S-698. Carbon Steel-Pin composition 1010, 1020 per QQ-N-461.
- E. Carbon Steel-Leaf-Cold-rolled, temper No. 4, per QQ-S-698.
- Copper-Pin-Alloy 260, temper half hard, per QQ-W-321.

FINISH:

Materials **A**, **B**, **C** and **D** shall be plain (uncoated). Materials **D** when specified, shall be zinc plated type II Class 2 of QQ-Z-325 or Cadmium plated type II class 1 of QQ-P-416. Materials **E** shall be cadmium plated type II Class 1 of QQ-P-416.

DIMENSIONS:

All dimensions are in inches unless otherwise specified.

PART NUMBER:

The **MS** part number consists of the MS number plus the dash number followed by the applicable letter for material.

Example: MS35821-6A or MS35821-8D. When protective finish is required for "D" materials, add F to the dash number. Example: MS35821-8DF.

- AN-251 HINGES
- AN-253 PINS
- MS-20253 PINS
- MS-27990 PINS
- NAS-40 EXTRUDED
- AN-252 EXTRUDED
- AN-250 BUTTS
- MS-7524 HINGES
- MIL-H-1237 BUTTS

ALL HINGES CUT TO SIZE, PIERCED OR FORMED TO PRINT

Plastic Hinges

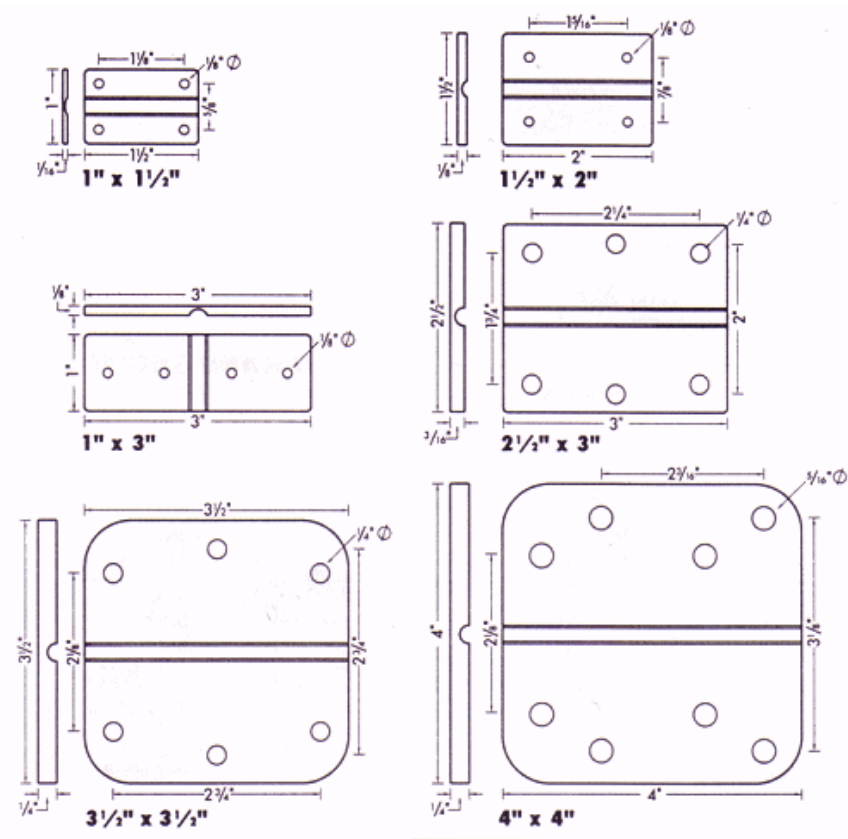

BUTT HINGES

- ◆ Available in a variety of colors; white, black, brown and gray.
- ◆ Installation is simple using rivets, screws, glue, brads, nails or staples on metal, wood or plastic surfaces.
- ◆ Economical alternative to metal hinges, particularly in medical, outdoor or harsh environments

Continuous Plastic Hinges

Continuous Hinge is a piano type of hinge made of flexible alloyed polymers. Available in 50' and 100' rolls and in open widths from 1-1/8" to 3", hinges can be cut to size for virtually any application.

Our one piece continuous hinge will not rust, tarnish, corrode, peel or bind, and never needs lubrication.

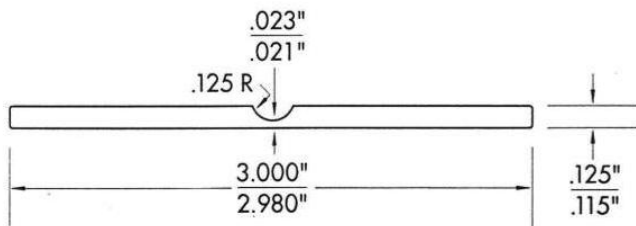

Typical Continuous Hinge Cross Section

- ◆ Material is modified Polyolefin copolymer
- ◆ Temperature - 40° to 180° F
- ◆ Chemical Resistance: Resists saltwater, oil, solvents, dilute acids and alkalines and most chemicals
- ◆ Excellent for cabinet doors, shutters, lids, covers, hatches and entry doors

Butt Hinges

Northeast Hinge Distributors carries a wide variety of butt hinges in stock. Listed is a small representation of what is readily available. You can choose from spun, staked, or loose pins. All hinges are also available swaged, formed, plated or painted. Please call us with your requirement.

Aluminum Butt Hinges

| STOCK NO. | THICKNESS | GAUGE | OPEN WIDTH | LENGTH | PIN DIA. |
|------------------|-----------|-------|------------|--------|----------|
| BTAC055150-150SP | .050 | 18 | 1-1/2 | 1-1/2 | 1/8 |
| BTAC065200-200SP | .062 | 16 | 2 | 2 | 1/8 |
| BTAC076200-200SP | .075 | 14 | 2 | 2 | 3/16 |
| BTA127300-300SP | .120 | 11 | 3 | 3 | 1/4 |
| BTAC127400-400SP | .120 | 11 | 4 | 4 | 1/4 |

*SP = Spun Pin *BTAC = Aluminum with Stainless Pin

Stainless Butt Hinges

| STOCK NO. | THICKNESS | GAUGE | OPEN WIDTH | LENGTH | PIN DIA. |
|-----------------|-----------|-------|------------|--------|----------|
| BTC055150-150SP | .050 | 18 | 1-1/2 | 1-1/2 | 1/8 |
| BTC065150-200S | .062 | 16 | 1-1/2 | 2 | 1/8 |
| BTC065200-200SP | .062 | 16 | 2 | 2 | 1/8 |
| BTC066150-200S | .062 | 16 | 1-1/2 | 2 | 3/16 |
| BTC076200-200SP | .075 | 14 | 2 | 2 | 3/16 |
| BTC076250-250SP | .075 | 14 | 2-1/2 | 2-1/2 | 3/16 |
| BTC096200-300SP | .090 | 13 | 2 | 3 | 3/16 |
| BTC127250-250SP | .120 | 11 | 2-1/2 | 2-1/2 | 1/4 |
| BTC127300-300SP | .120 | 11 | 3 | 3 | 1/4 |
| BTC127600-600SP | .120 | 11 | 6 | 6 | 1/4 |
| BTC188400-400SP | .187 | 7 | 4 | 4 | 3/8 |

*S = Staked Pin *SP = Spun Pin

Steel Butt Hinges

| STOCK NO. | THICKNESS | GAUGE | OPEN WIDTH | LENGTH | PIN DIA. |
|-----------------|-----------|-------|------------|--------|----------|
| BTS033150-100S | .035 | 20 | 1-1/2 | 1 | 11/16 |
| BTS033106-125S | .035 | 20 | 1-1/16 | 1-1/4 | 11/16 |
| BTS033150-150S | .035 | 20 | 1-1/2 | 1-1/2 | 11/16 |
| BTS033200-200S | .035 | 20 | 2 | 2 | 11/16 |
| BTS055150-150SP | .050 | 18 | 1-1/2 | 1-1/2 | 1/8 |
| BTS065150-150S | .062 | 18 | 1-1/2 | 1-1/2 | 1/8 |
| BTS065150-150SP | .062 | 16 | 1-1/2 | 1-1/2 | 1/8 |
| BTS065150-200SP | .062 | 16 | 1-1/2 | 2 | 1/8 |
| BTS065200-200S | .062 | 16 | 2 | 2 | 1/8 |
| BTS065200-200SP | .062 | 16 | 2 | 2 | 1/8 |
| BTS076200-200SP | .075 | 14 | 2 | 2 | 3/16 |
| BTS096200-300SP | .090 | 13 | 2 | 3 | 3/16 |
| BTS097300-300SP | .090 | 13 | 3 | 3 | 1/4 |
| BTS127250-250SP | .120 | 11 | 2-1/2 | 2-1/2 | 1/4 |
| BTS127300-300L | .120 | 11 | 3 | 3 | 1/4 |
| BTS127300-300SP | .120 | 11 | 3 | 3 | 1/4 |
| BTS127350-350SP | .120 | 11 | 3-1/2 | 3-1/2 | 1/4 |
| BTS127300-400SP | .120 | 11 | 3 | 4 | 1/4 |
| BTS127400-400L | .120 | 11 | 4 | 4 | 1/4 |
| BTS127400-400SP | .120 | 11 | 4 | 4 | 1/4 |
| BTS127500-500SP | .120 | 11 | 5 | 5 | 1/4 |
| BTS188400-400SP | .187 | 7 | 4 | 4 | 3/8 |
| BTS188600-600SP | .187 | 7 | 6 | 6 | 3/8 |

*S = Staked Pin *SP = Spun Pin *L = Removable Pin

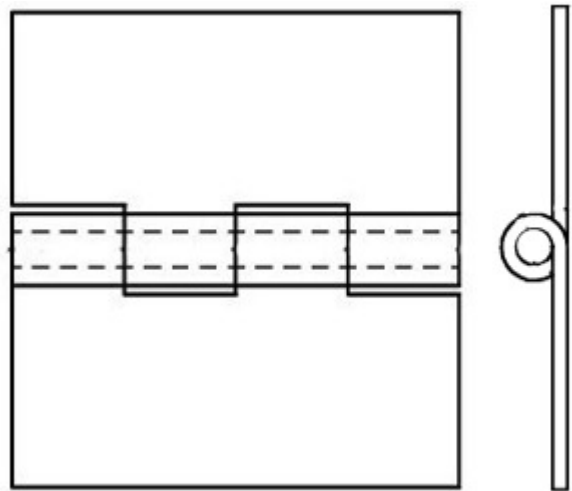

Any of the butt hinges on this page may be modified to include holes. Email us your print and we can provide a quote

Plated Butt Hinge with Holes

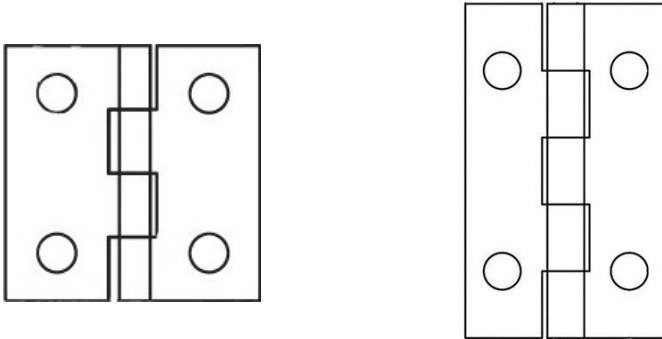

These hinges are light weight for smaller applications such as jewelry boxes, picnic baskets, and many other small craft items. The hinges have a staked pin and 2 holes in each leaf.

| STOCK NO. | FINISH | THICKNESS | GAUGE | OPEN WIDTH | LENGTH | PIN DIA. |
|-----------------|--------|-----------|-------|------------|--------|----------|
| BTPN021075-100H | Nickel | .025 | 24 | 3/4 | 1 | .062 |
| BTPN033106-100H | Nickel | .035 | 20 | 1-1/16 | 1 | .086 |
| BTPN033125-125H | Nickel | .035 | 20 | 1-1/4 | 1-1/4 | .086 |
| BTPN042125-150H | Nickel | .040 | 19 | 1-1/4 | 1-1/5 | .080 |
| BTPB021075-100H | Brass | .025 | 24 | 3/4 | 1 | .062 |
| BTPB033106-100H | Brass | .035 | 20 | 1-1/16 | 1 | .086 |
| BTPB033200-100H | Brass | .035 | 20 | 2 | 1 | .086 |

Electrical Panel Box Hinge

Concealed hinges keep hinge out of sight when door is closed. One leaf of these concealed hinges swings the door out.

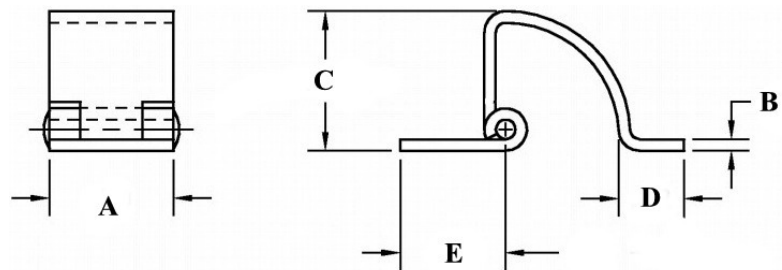

| Stock No. | Material | A Length | B Thickness | C Height | D Width | E Width | Radius | Pin Dia. |
|-----------|-----------|----------|-------------|----------|---------|---------|--------|----------|
| EPHS80 | Steel | .80 | .075 | .90 | .42 | .68 | 17/32 | .125 |
| EPHS125 | Steel | 1.25 | .090 | 1.06 | .68 | .95 | 17/32 | .187 |
| EPHS200 | Steel | 2.00 | .060 | .750 | .625 | .68 | 17/32 | .130 |
| EPHC80 | Stainless | .80 | .075 | .90 | .42 | .68 | 17/32 | .125 |
| EPHC125 | Stainless | 1.25 | .090 | 1.06 | .68 | .95 | 17/32 | .187 |

Spring Hinges

No Holes

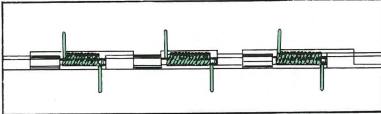

Open with no holes

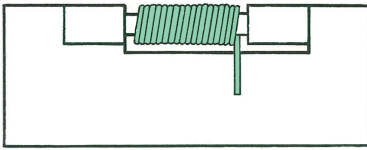

Closed with no holes

| PART NO. | LENGTH | OPEN WIDTH | THICKNESS | MATERIAL | LOADING POSITION | # OF SPRINGS |
|------------------|--------|------------|-----------|-----------|------------------|--------------|
| SPS021075-125O | 1.25 | .75 | .025 | Steel | Open | 1 |
| SPC021075-125O | 1.25 | .75 | .025 | Stainless | Open | 1 |
| SPS021075-125C | 1.25 | .75 | .025 | Steel | Closed | 1 |
| SPC021075-125C | 1.25 | .75 | .025 | Stainless | Closed | 1 |
| SPS033150-175O | 1.75 | 1.50 | .035 | Steel | Open | 1 |
| SPC033150-175O | 1.75 | 1.50 | .035 | Stainless | Open | 1 |
| SPS044150-350O | 3.50 | 1.50 | .040 | Steel | Open | 1 |
| SPC044150-350O | 3.50 | 1.50 | .040 | Stainless | Open | 1 |
| SPS044150-350C | 3.50 | 1.50 | .040 | Steel | Closed | 1 |
| SPC044150-350C | 3.50 | 1.50 | .040 | Stainless | Closed | 1 |
| SPS065150-3.25O | 3.25 | 1.50 | .060 | Steel | Open | 1 |
| SPS065150-3.25C | 3.25 | 1.50 | .060 | Steel | Closed | 1 |
| SPC065150-3.25O | 3.25 | 1.50 | .060 | Stainless | Open | 1 |
| SPC065150-3.25C | 3.25 | 1.50 | .060 | Stainless | Closed | 1 |
| SPS065150-5.375C | 5.375 | 1.50 | .060 | Steel | Closed | 2 |
| SPS065150-5.375O | 5.375 | 1.50 | .060 | Steel | Open | 2 |
| SPC065150-5.375C | 5.375 | 1.50 | .060 | Stainless | Closed | 2 |
| SPC065150-5.375O | 5.375 | 1.50 | .060 | Stainless | Open | 2 |

The above spring hinges are usually stock items. Most spring hinges are custom made to suit your requirements. Spring hinges may be made in any material, gauge, and length desired. We will work with you on any particular tension requirement you need. We welcome your blueprint or sketch.

With Holes

| PART NO. | LENGTH | OPEN WIDTH | THICKNESS | MATERIAL | LOADING POSITION | # OF SPRINGS |
|-------------------|--------|------------|-----------|------------|------------------|--------------|
| SPSZ021075-125HO | 1.25 | .75 | .025 | Steel/Zinc | Open | 1 |
| SPC021075-125HO | 1.25 | .75 | .025 | Stainless | Open | 1 |
| SPSZ033150-175HO | 1.75 | 1.50 | .035 | Steel/Zinc | Open | 1 |
| SPC033150-175HO | 1.75 | 1.50 | .035 | Stainless | Open | 1 |
| SPC033100-200HO | 2.00 | 1.00 | .035 | Stainless | Open | 1 |
| SPSZ044100-200HC | 2.00 | 1.00 | .040 | Steel/Zinc | Closed | 1 |
| SPSZ044100-200HO | 2.00 | 1.00 | .040 | Steel/Zinc | Open | 1 |
| SPC033100-200HC | 2.00 | 1.00 | .035 | Stainless | Closed | 1 |
| SPSZ044150-350HO | 3.50 | 1.50 | .040 | Steel/Zinc | Open | 1 |
| SPC044150-350HO | 3.50 | 1.50 | .040 | Stainless | Open | 1 |
| SPC044150-350HC | 3.50 | 1.50 | .040 | Stainless | Closed | 1 |
| SPC065150-325HC | 3.25 | 1.50 | .060 | Stainless | Closed | 1 |
| SPS065150-325HC | 3.25 | 1.50 | .060 | Steel | Closed | 1 |
| SPS055150-5.375HO | 5.375 | 1.50 | .050 | Steel | Open | 2 |
| SPC055150-5.375HC | 5.375 | 1.50 | .050 | Stainless | Closed | 2 |
| SPC055150-5.375HO | 5.375 | 1.50 | .050 | Stainless | Open | 2 |
| SPC055150-5.375HC | 5.375 | 1.50 | .050 | Stainless | Closed | 2 |
| SPS065150-36.00HC | 36.00 | 1.50 | .060 | Steel | Closed | 5 |

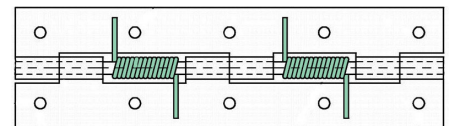

Open with holes

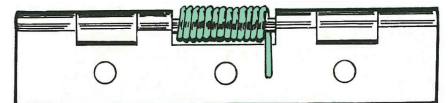

Closed with holes

Toll Free: 1-800-882-0120

or (603) 465-3244

FAX: (603) 465-3313

P.O. Box 891, 261 Proctor Hill Road, Hollis, NH 03049

Email: nehinge@nehinge.com

www.nehinge.com



Adjustable Spring Hinges

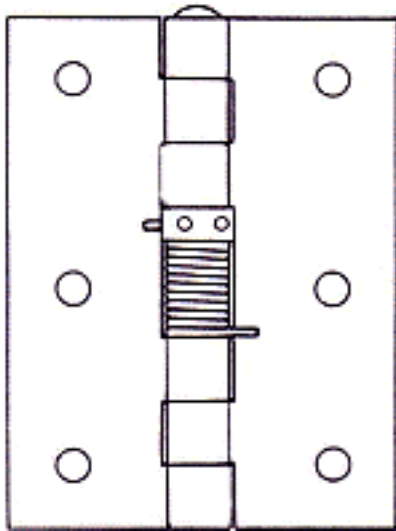

ADJUSTABLE

STAINLESS SPRING HINGES

Primarily used on pool gates and around corrosive environments where a spring is required. Adjustability allows for different tension, for different size gates or doors. It is recommended that a minimum of two spring hinges be used for each application.

- ◆ All stainless construction
- ◆ Surface mount
- ◆ Adjustable tension
- ◆ Loose pin
- ◆ Available in 3" X 4", 4" X 4"

Single Acting Spring Hinges

FULL MORTISE

Features

UL Listed for fire door applications
Non-handed
Steel material
Easily adjusted spring tension screw
hole pattern conforms to ANSI
specifications
Pivot point aligns with hinges of the
same size

Uses

Minimizes cost of installing a door
closing device on industrial,
commercial, institutional and
residential applications
Used to convert doors to self-closing in
existing buildings
For use in hotels, motels, apartments,
dormitories, residences, etc., where
doors are required to be self closing
(always verify local fire code requirements)

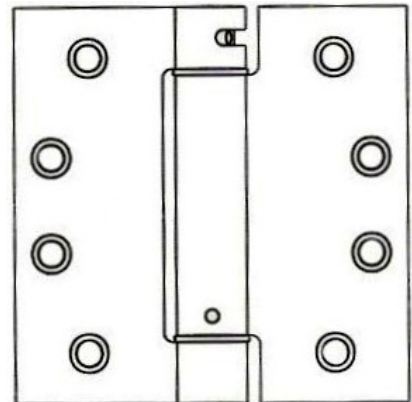
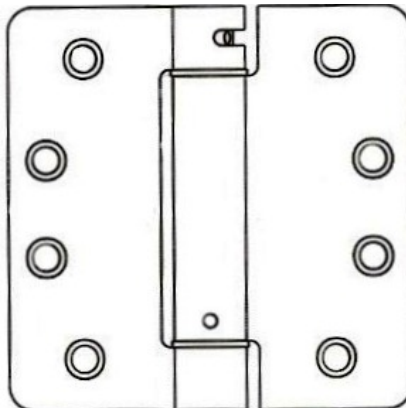
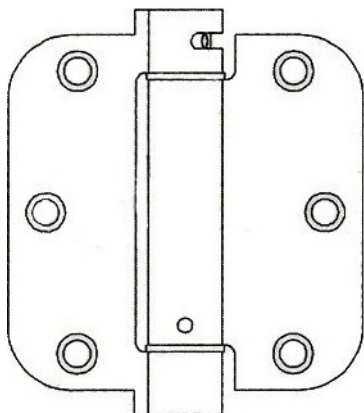

Spring Release Hinges

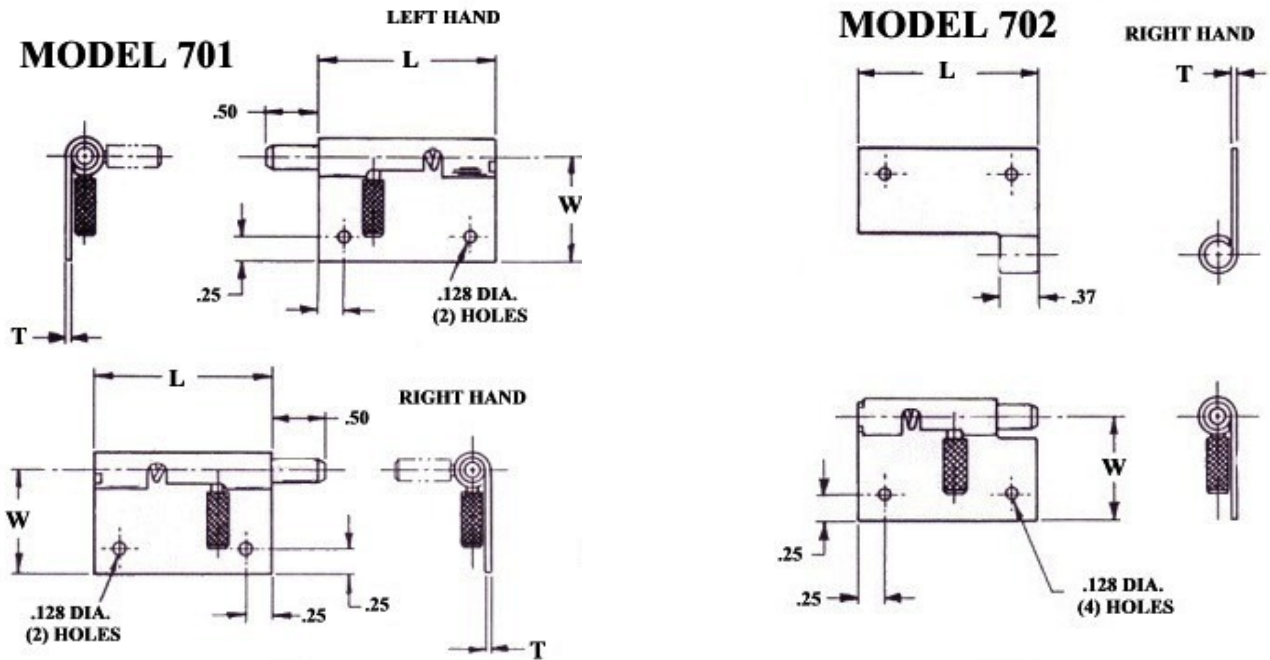

| BODY | | | | |
|--|-----------------|----------|----------|-----------|
| | | Standard | Special | |
| L | Length | 1.75 | | |
| W | Width | 1.00 | | |
| Dash # | | -1 | -7 | |
| PIN | | | | |
| P | Pin Diameter | .250 | .281 | Special |
| T | Metal Thickness | .050 | .062 | Special |
| Dash # | | -1 | -2 | -7 |
| HOLES | | | | |
| | | None | Standard | Special |
| Dash # | | -0 | -1 | -7 |
| MATERIAL | | | | |
| | | Aluminum | Steel | Stainless |
| Dash # | | -1 | -2 | -3 |
| MODEL | | | | |
| R | Right | | | |
| L | Left | | | |
| FINISH | | | | |
| Most commercial finishes are available including zinc on steel, passivate or electro polish on stainless steel and anodizing aluminum. | | | | |

ORDERING INFORMATION

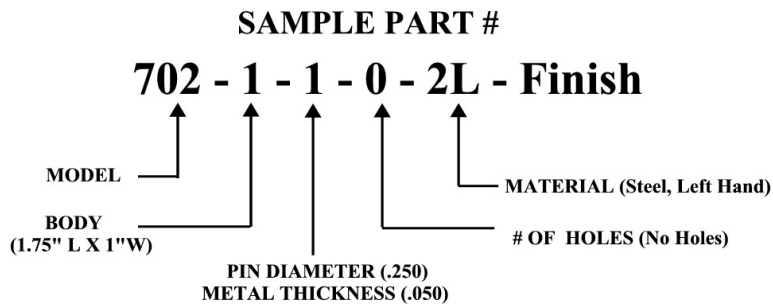

Spring Release Hinges

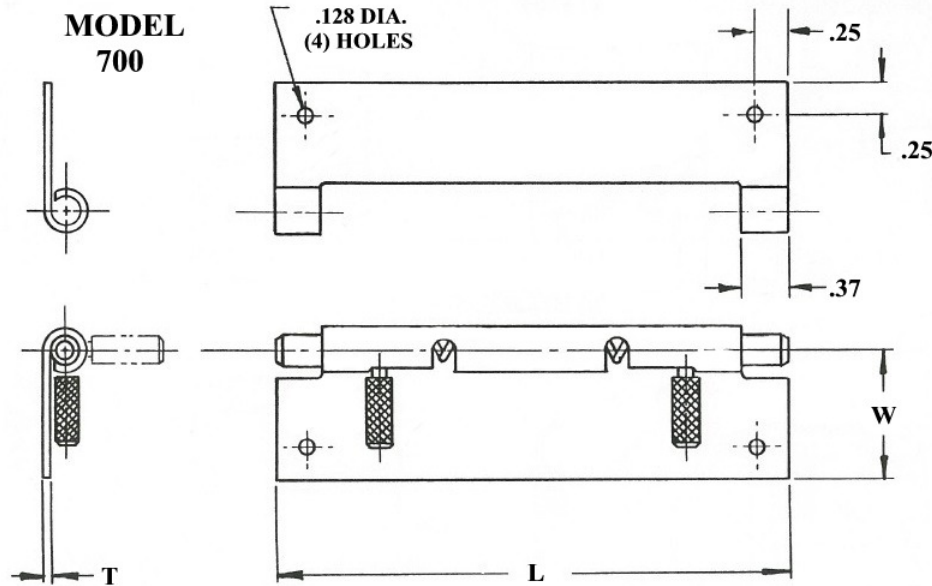

| BODY | | | | | |
|--|-----------------|-------------|---------------|----|--------------------------|
| L | Length | 3" | 4" | 6" | Special |
| W | Width | 1" | 1" | 1" | Special |
| Dash # | | -3 | -4 | -6 | -7 |
| PIN | | | | | |
| P | Pin Diameter | .250 | .281 | | Special |
| T | Metal Thickness | .050 | .062 | | Special |
| Dash # | | -1 | -2 | | -7 |
| HOLES | | | | | |
| | | None | Standard | | Special |
| Dash # | | -0 | -1 | | -7 |
| MATERIAL | | | | | |
| | | Aluminum | Steel | | Stainless |
| Dash # | | -1 | -2 | | -3 |
| MODEL | | | | | |
| | | Male | Female | | Complete Assembly |
| | | -1 | -2 | | -A |
| FINISH | | | | | |
| Most commercial finishes are available including zinc on steel, passivate or electro polish on stainless steel and anodizing aluminum. | | | | | |

SPRING RELEASE HINGES

Combining a hinge and a latch is a standard piece of hardware.

The Spring Release Hinge has either a pair of spring-loaded handles or a single handle, which pulls toward the center to release the body or door from the keeper. An alternate style relies on an engagement hole or slot in the adjoining surface.

Installation is simple and inexpensive using screws, rivets or by welding

All styles are manufactured to close tolerances. End play and side play are held to a minimum, insuring a precision fit and smooth operation.

ORDERING INFORMATION

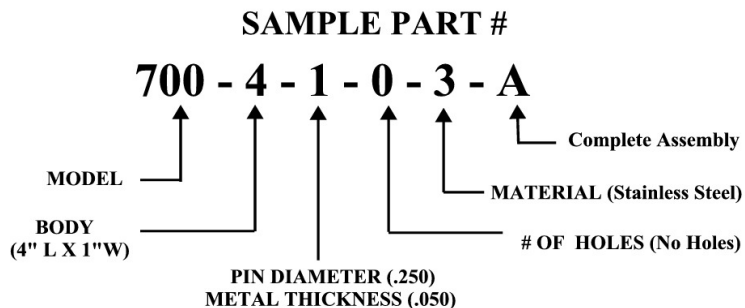

Latch Hinges

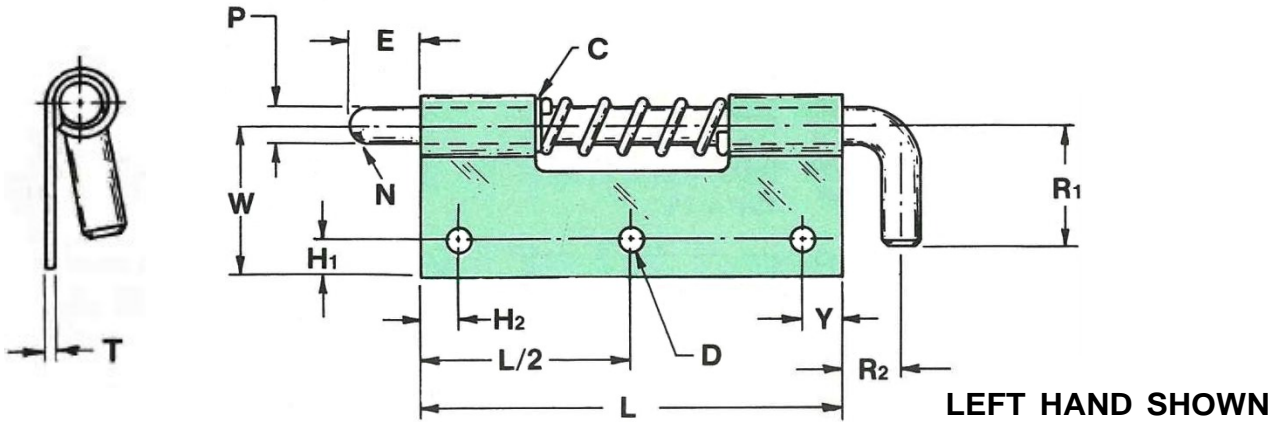

DIMENSIONS

(Standard Sizes Listed)

| PART NO. | 711 | 712 | 713 | 714 | |
|----------|------------------|------|-------|-------|-------|
| L | Body Length | .875 | 1.375 | 2.000 | 2.750 |
| *W | Body Width (A) | .375 | .500 | .625 | .750 |
| | (B) | .500 | .750 | .875 | 1.000 |
| T | Body Thickness | .035 | .040 | .050 | .060 |
| P | Pin Diameter | .125 | .156 | .187 | .250 |
| *E | Pin Extension | .187 | .250 | .675 | .500 |
| R1 | Handle Length | .437 | .625 | .687 | .812 |
| R2 | Handle Extension | .187 | .250 | .312 | .375 |
| *H1 | Hole Location | .156 | .187 | .187 | .250 |
| *H2 | Hole Location | .156 | .187 | .250 | .250 |
| D | Hole Diameter | .128 | .128 | .128 | .128 |

*Dimensions that can be altered to meet your specifications

POINT STYLE



MATERIAL

| | | | |
|--------|-----------------|---------------------------|---------------------|
| BODY | Steel (1010)(S) | Stainless Steel (302) (C) | Aluminum (A) |
| PIN | Steel (12L14) | Stainless Steel (302) | Aluminum (5052) |
| SPRING | Steel (1065) | Stainless Steel (302) | |
| C-RING | Steel (1060) | Stainless Steel (AISI632) | |
| FINISH | Zinc | | Anodized (Aluminum) |

MODELS

Available in Right Hand (R) or Left Hand (L) models. Special Forms, Offsets, Swaging or Welding Projections available. Latch can be furnished assembled, unassembled or body only.

ORDERING INFORMATION

| BASIC PART # | MATERIAL | MODEL | BODY WIDTH | POINT STYLE |
|--------------|---------------------|----------------|----------------|--------------|
| 711 | S (Steel) | R (Right Hand) | A (See Design) | 1 (90° Cone) |
| 712 | C (Stainless Steel) | L (Left Hand) | B (Spec.) | 2 (Ball) |
| 713 | A (Aluminum) | | | 3 (Bullet) |
| 714 | | | | 4 (Flat) |
| | | | | 5 (60° Cone) |

*Example **712CLA3** (1-3/8 Body, Stainless Steel, Left Hand, 1/2 Body Width, Bullet Point)

Heavy Duty Spring Latch

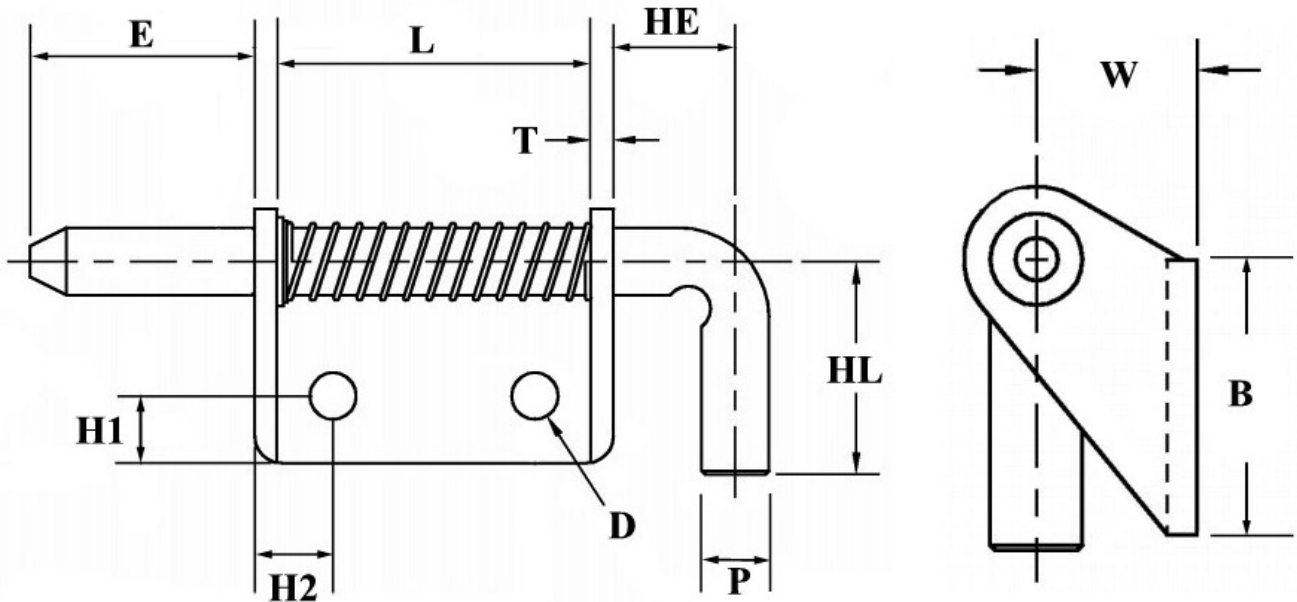

Available in 3/8" and 1/2" carbon steel pin diameters. These large rugged latches are available in steel or stainless steel and have a closed knuckle for added durability and strength.

| HEAVY DUTY SPRING LATCH PART NUMBERS | | | |
|--------------------------------------|--|-------|-------|
| | | 719 | 720 |
| PIN (01) | | | |
| P | Pin Diameter | .375 | .500 |
| E | Extension | 1.250 | 1.500 |
| HL | Handle Length | 1.187 | 1.218 |
| HE | Handle Extension | .687 | 1.000 |
| BODY(02) | | | |
| L | Length | 2.000 | 3.000 |
| W | Width | 1.125 | 1.250 |
| B | Height | .656 | .750 |
| T | Thickness | .12 | .19 |
| H1 | Hole Location | .375 | .500 |
| H2 | Hole Location | .437 | .625 |
| D | Hole Diameter | .265 | .328 |
| MATERIALS | | | |
| C | Stainless | | |
| S | Steel | | |
| MODELS | | | |
| R | Right Hand | | |
| L | Left Hand | | |
| U | Unassembled | | |
| FINISH | Most finishes are available, including zinc on steel, passivate and electro-polishing on stainless steel | | |

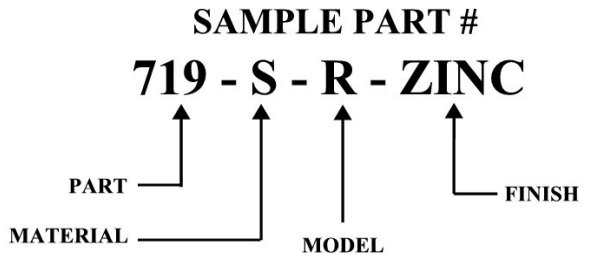

Slam Latches

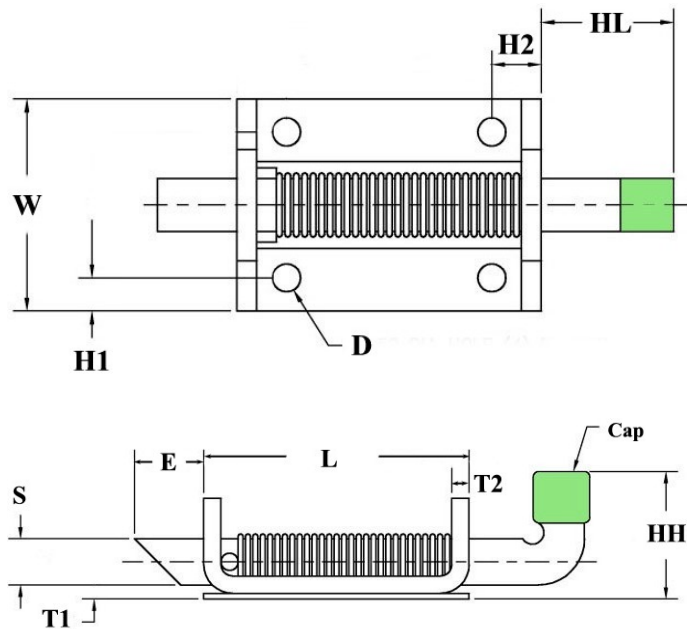

Available in 3 sizes: 7/16", 3/8", and 1/2" carbon steel pin diameters. These rugged latches are ideal for doors, drawers, truck/trailer bodies, construction, farm equipment and all aircraft applications.

| SLAM LATCH PART NUMBERS | | | | |
|--|--|-------|-------|-------|
| | | 707 | 708 | 709 |
| S E HLHH | SHAFT (01) | | | |
| | Shaft Thickness | .375 | .437 | .500 |
| | Extension | .562 | .750 | .750 |
| | Handle Length | .812 | 1.000 | 1.250 |
| | Handle Height | 1.000 | 1.250 | 1.375 |
| L W T1 T2 H1 H2 D | BODY(02) | | | |
| | Length | 1.500 | 2.000 | 2.875 |
| | Width | 1.250 | 1.625 | 2.000 |
| | Thickness | .115 | .125 | .150 |
| | Thickness | .09 | .12 | .19 |
| | Hole Location | .187 | .250 | .312 |
| | Hole Location | .250 | .375 | .468 |
| | Hole Diameter | .171 | .203 | .203 |
| C S | MATERIALS | | | |
| | Stainless Steel | | | |
| FINISH | Most finishes are available, including zinc on steel, passivate and electro-polishing on stainless steel, anodize on aluminum, and nickel on brass | | | |

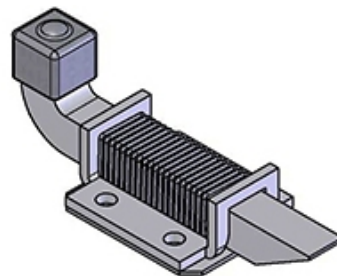

SAMPLE PART #
707 - S - 0 - ZINC

MODEL → 707
MATERIAL → S
COVER → 0
FINISH (Zinc) → ZINC

COVER
0 = No Cover
1 = With Cover

Weld-On Hinges

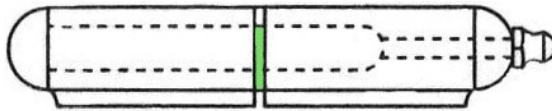
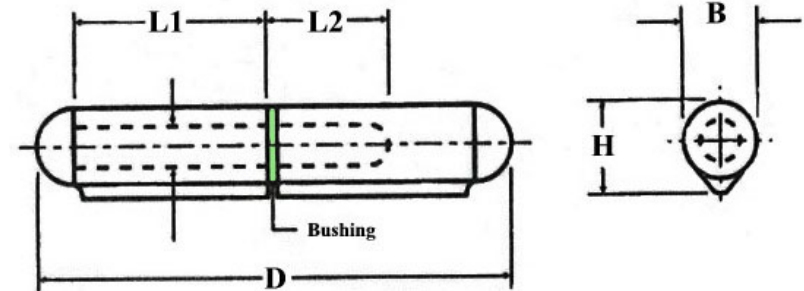

Fixed Pin with Grease Fitting

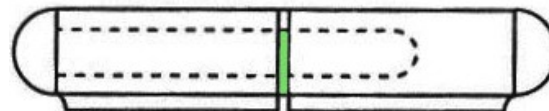

Fixed Pin

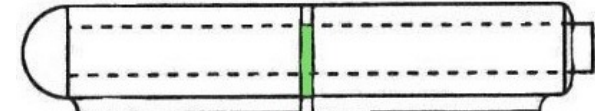

Removeable Pin

| Steel/ Steel Pin | Steel/ Brass Pin | Steel/ Steel Pin Grease Fitting | Steel/ Brass Pin Grease Fitting | Steel/ Steel Loose Pin | Stainless | Aluminum/ Stainless Pin | Length L | Thick H | Dia. B | L1 | L2 | Pin Dia. D |
|---------------------|---------------------|---------------------------------------|---------------------------------------|------------------------------|-----------|-------------------------------|-------------|------------|-----------|------|------|---------------|
| SWH158FP | SBWH158FP | - | - | - | CWH158FP | ACWH158FP | 1.58 | 0.37 | 0.315 | 0.63 | 0.58 | 0.197 |
| SWH200FP | SBWH200FP | - | - | SWH250LP | CWH200FP | ACWH200FP | 2.00 | 0.38 | 0.315 | 0.79 | 0.58 | 0.197 |
| SWH237FP | SBWH237FP | - | - | - | CWH237FP | ACWH237FP | 2.37 | 0.46 | 0.394 | 0.93 | 0.70 | 0.236 |
| SWH275FP | SBWH275FP | - | - | - | CWH275FP | ACWH275FP | 2.75 | 0.51 | 0.450 | 1.13 | 0.85 | 0.236 |
| SWH318FP | SBWH318FP | SWH318GF | SWH318GF | SWH318LP | CWH318FP | ACWH318FP | 3.18 | 0.61 | 0.510 | 1.29 | 0.85 | 0.315 |
| SWH400FP | SBWH400FP | SWH400GF | SWH400GF | SWH400LP | CWH400FP | ACWH400FP | 4.00 | 0.77 | 0.630 | 1.63 | 1.20 | 0.394 |
| SWH475FP | SBWH475FP | SWH475GF | SWH475GF | - | CWH475FP | - | 4.75 | 0.76 | 0.625 | 2.04 | 1.30 | 0.394 |
| SWH525FP | SBWH525FP | - | - | - | CWH525FP | ACWH525FP | 5.25 | 0.90 | 0.709 | 2.25 | 1.50 | 0.500 |
| SWH600FP | SBWH600FP | SWH600GF | SWH600GF | SWH600LP | CWH600FP | ACWH600FP | 6.00 | 1.00 | 0.787 | 2.54 | 1.63 | 0.500 |
| SWH700FP | SBWH700FP | SWH700GF | SWH700GF | - | - | ACWH700FP | 7.00 | 1.00 | 0.787 | 3.15 | 1.92 | 0.510 |
| SWH800FP | SBWH800FP | SWH800GF | SWH800GF | SWH800LP | CWH800FP | ACWH800FP | 8.00 | 1.13 | 0.906 | 3.44 | 2.05 | 0.625 |
| SWH1000FP | SBWH1000FP | SWH1000GF | SWH1000GF | - | - | - | 10.00 | 1.46 | 1.102 | 4.60 | 2.87 | 0.750 |

Note: All dimensions are in decimal inches. For steel hinges, bushing is brass. On stainless steel and aluminum hinges, bushing is stainless steel

NORTHEAST HINGE DISTRIBUTORS, INC.

261 Proctor Hill Road

PO BOX 891

Hollis NH 03049-0891

1-800-882-0120

Fax: 603-465-3313

Email: nehinge@nehinge.com

- ◆Weld-on hinges offer less side play and much better axial alignment than traditional hinges
- ◆Optional grease fitting helps prevent corrosion
- ◆Provides less sag than butts or slip joints
- ◆Ideal for a wide range of applications, everything from truck bodies, enclosures, containers or electrical equipment

Slip-Joint Hinges

Slip-joint hinges are commonly used when requirements call for doors to be removed. Indicate right or left hand when ordering. All hinges can be pierced, countersunk, and plated to your specifications. If you do not see the size want listed, please contact us. It is our goal to provide you with what you need.

Steel

| STOCK NO. | THICKNESS | GAUGE | LENGTH | OPEN WIDTH | PIN DIA. |
|---------------|-----------|-------|--------|------------|----------|
| SJS075168-200 | .075 | 14 | 2 | 1.68 | .125 |
| SJS076187-250 | .075 | 14 | 2-1/2 | 1.87 | .187 |
| SJS076200-200 | .075 | 14 | 2 | 2 | .187 |
| SJS096250-250 | .093 | 13 | 2-1/2 | 2.5 | .187 |
| SJS097300-300 | .093 | 13 | 3 | 3 | .250 |
| SJS127400-400 | .120 | 11 | 4 | 4 | .250 |

Aluminum with Stainless Pin

| STOCK NO. | THICKNESS | GAUGE | LENGTH | OPEN WIDTH | PIN DIA. |
|---------------|-----------|-------|--------|------------|----------|
| SJA076168-200 | .075 | 14 | 2 | 1.68 | .187 |

Stainless

| STOCK NO. | THICKNESS | GAUGE | LENGTH | OPEN WIDTH | PIN DIA. |
|----------------|-----------|-------|--------|------------|----------|
| SJC076168-200 | .075 | 14 | 2 | 1.68 | .187 |
| SJC076168-200 | .075 | 14 | 2 | 1.68 | .187 |
| SJC076168-200H | .075 | 14 | 2 | 1.68 | .187 |
| SJC076250-250 | .075 | 14 | 2-1/2 | 2-1/2 | .187 |
| SJC096200-300 | .093 | 13 | 3 | 2 | .187 |
| SJC097300-300 | .093 | 13 | 3 | 3 | .250 |

*H = Holes

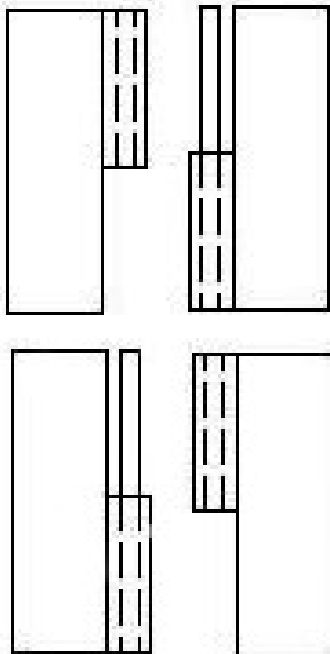

Right Hand

Left Hand

Listed above are our standard stock items. Customize sizes are also available. Give us a call at 1-800-882-0120 or email us at nehinge@nehinge.com for a quote

| STEEL | ALUMINUM | STAINLESS | NICKEL PLATED | THICKNESS | GAUGE | LENGTH | OPEN WIDTH | PIN DIA. |
|---------------|---------------|---------------|----------------|-----------|-------|--------|------------|----------|
| SJS051144-150 | SJA055144-150 | SJC055144-150 | SJS055144-150H | .050 | 18 | 1-1/2 | 1.44 | .120 |

H = Holes

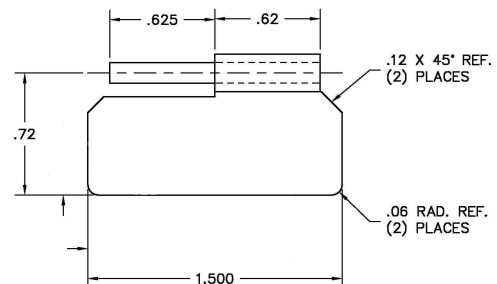
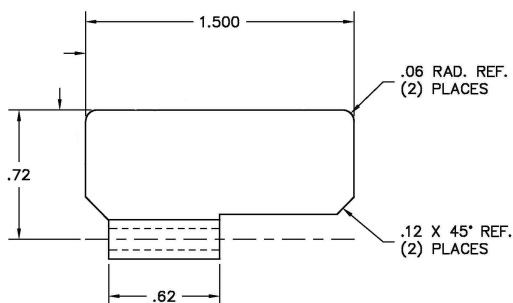

Prints with holes are available upon request

Flag Hinges

Flag hinges are commonly used when requirements call for doors to be removed. Indicate right or left hand when ordering. All hinges can be pierced, countersunk, swaged and plated to your requirements

Steel

| STOCK NO. | THICKNESS | GAUGE | LENGTH | OPEN WIDTH | PIN DIA. |
|---------------|-----------|-------|--------|------------|----------|
| FLG055356-200 | .050 | 18 | 2 | .68 | .130 |

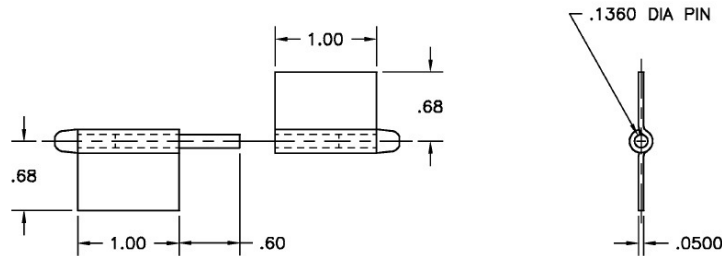

| STOCK NO. | THICKNESS | GAUGE | LENGTH | OPEN WIDTH | PIN DIA. |
|---------------|-----------|-------|--------|------------|----------|
| FLG064120-237 | .062 | 16 | 2.37 | 1.20 | .156 |

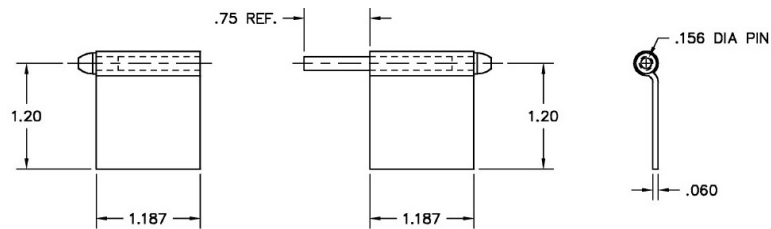

Listed are our standard stock items, If your requirements are different, just call us! Nothing is too "special" for us.

Stainless

| STOCK NO. | THICKNESS | GAUGE | LENGTH | OPEN WIDTH | PIN DIA. |
|----------------|-----------|-------|--------|------------|----------|
| FLGC055100-200 | .050 | 18 | 2 | 1 | .120 |

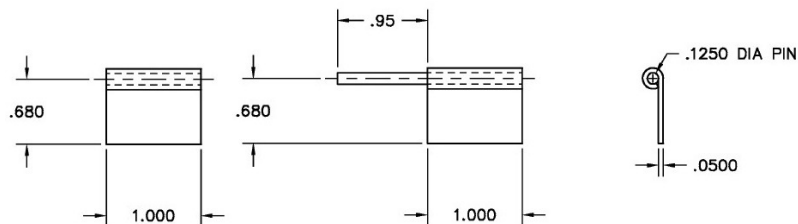

Stainless Steel Electro Polished Hinges

Hinges are Made of Marine Grade Stainless Steel
(T 302/304) 16 Gauge

Electro Polish Stainles Steel Hinges have countersunk holes with a staked pin.

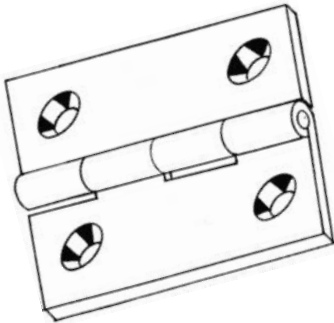

Butt Hinge
2" x 2"
1-1/2" x 2"

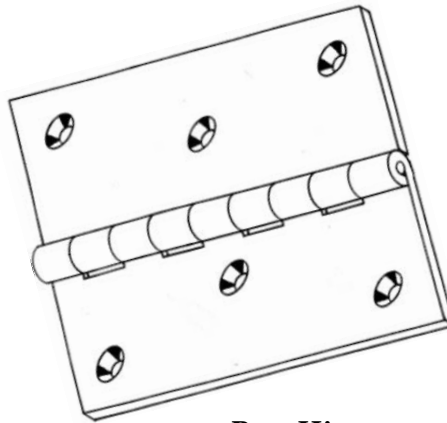

Butt Hinge
3" x 3"

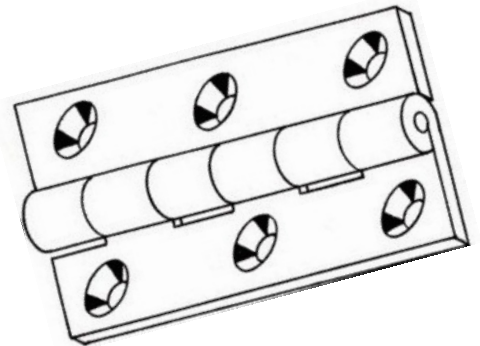

Butt Hinge
2" x 3"

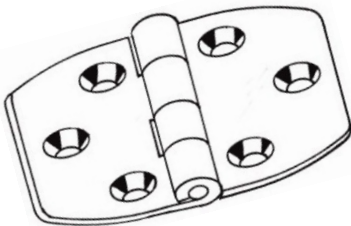

Tapered Butt Hinge
2-3/4" x 1-1/2"

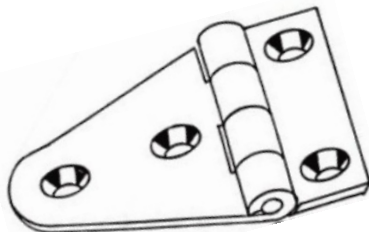

T-Hinge
2" or 3"

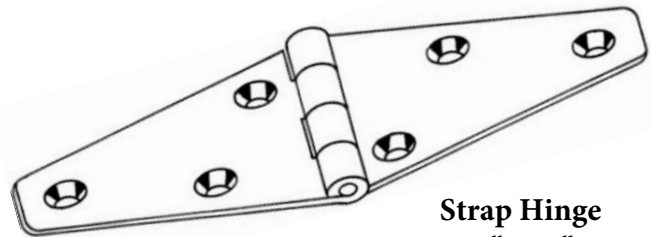

Strap Hinge
5" or 6"

Northeast Hinge



Distributors, Inc.

Conditions of Sale

• **HINGES** •

Performance: Northeast Hinge shall furnish your order free from defects in material and workmanship. Further, your order will be supplied per your print specifications unless otherwise notified in writing.

Credit: Orders received will be shipped on an open account basis to firms with a satisfactory known credit rating. Firms must submit a complete credit reference application. To expedite your initial order, you may request shipment to be made C.O.D. until credit can be established or by VISA or MasterCard

Terms: All payments are due net 30 days from date of invoice. 1% cash discount on goods is allowed when payment is received 10 days from date of the invoice.

Freight: All shipments are F.O.B. ship point. Our shipping department will route via the cheapest and most reliable carriers in the event you do not designate one. All small package shipments will be made prepaid, fully insured and added to the invoice unless customer specifies an alternative method

Returns: We will not accept for credit any material which has been produced per the specifications of the customer. To return standard catalog items for credit, you must receive permission. A 15% restocking and handling charge will be assessed upon any return. All returns must be shipped "Prepaid".

In the event you receive a shipment which does not meet with the specifications of your order, please notify us within 30 days of the receipt of said shipment. When writing, please be sure to include a sample of the defective part. We will advise you immediately upon receipt of your sample regarding a replacement and disposition of the defective goods.

Overruns: We reserve the right to ship and invoice over quantities by 5%



Toll Free: **1-800-882-0120**
or (603) 465-3244
FAX: (603) 465-3313
P.O. Box 891, 261 Proctor Hill Road, Hollis, NH 03049
Email: nehinge@nehinge.com
www.nehinge.com

**Your Stocking Source for
Continuous Hinges & All
Other Hinges**

Northeast Hinge Distributors, Inc.

**SPECIALIZING
IN CUSTOM
REQUIREMENTS
OFTEN WITH
A QUICK
TURNAROUND**

**P.O. BOX 891
261 Proctor Hill Road
Hollis NH 03049**

**(603) 465-3244
(603) 465-3264
FAX (603) 465-3313**

**1-800-882-0120
nehinge@nehinge.com
www.nehinge.com**